

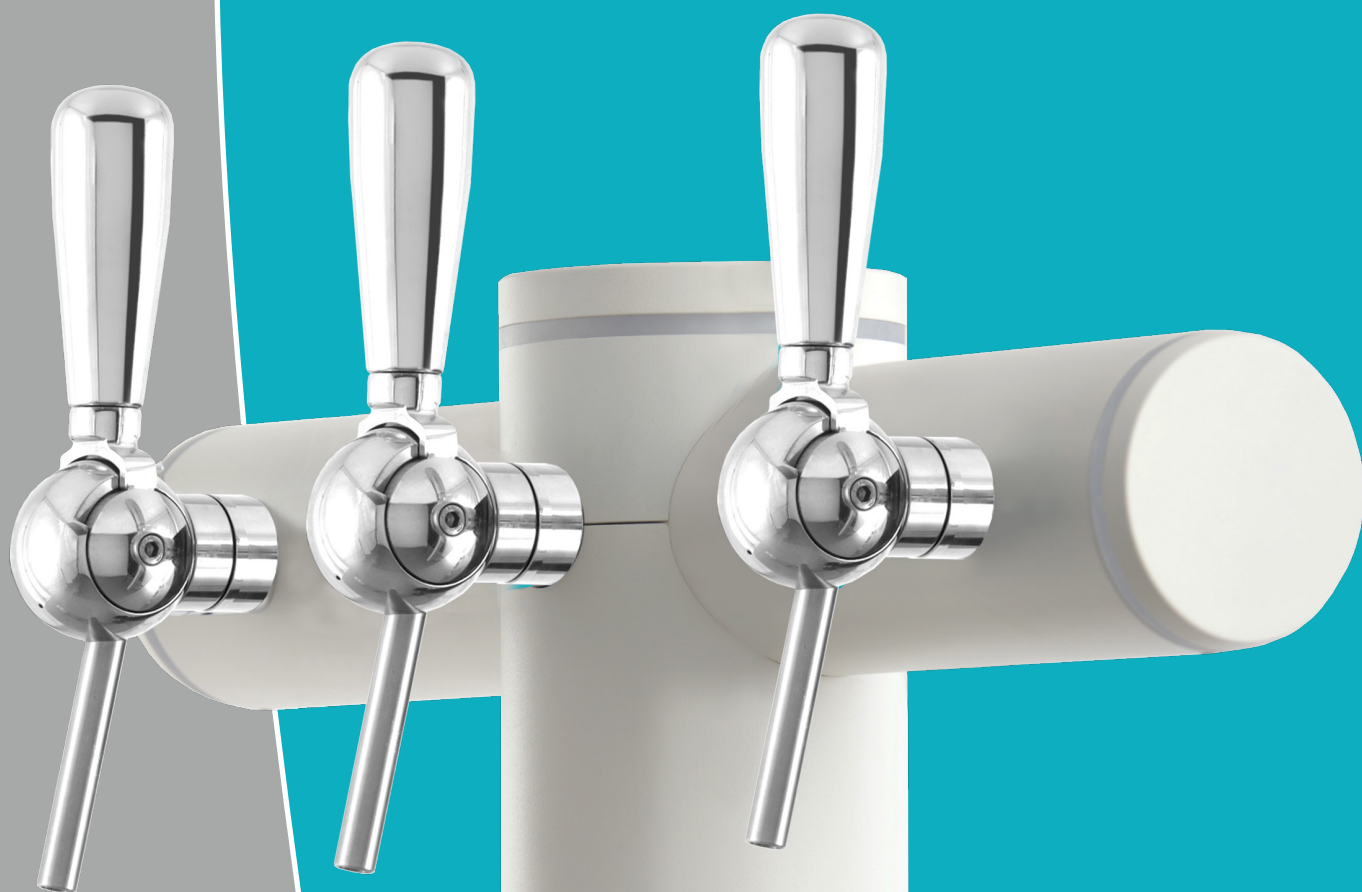

Since 1932

2018



Equipement pour  
le service de la bière

Uitrusting voor  
het tappen van bier

# Made in Belgium

SA ANTOINE NV  
SA VERVENNE & VAN BELLE NV

Rue de la Bienvenue, 7-9, 1070 Bruxelles  
Verwelkomingsstraat 7-9, 1070 Brussel  
T +32 2 523 94 30  
[info@antoinebelgium.be](mailto:info@antoinebelgium.be)  
[www.antoine-belgium.com](http://www.antoine-belgium.com)  
[sales@vvb.be](mailto:sales@vvb.be) • [www.vvb.be](http://www.vvb.be)

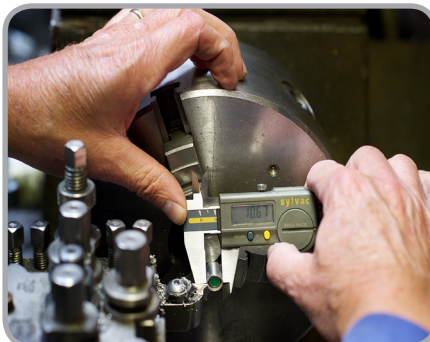

15 000m<sup>2</sup> d'usine



Production verte  
Groene productie



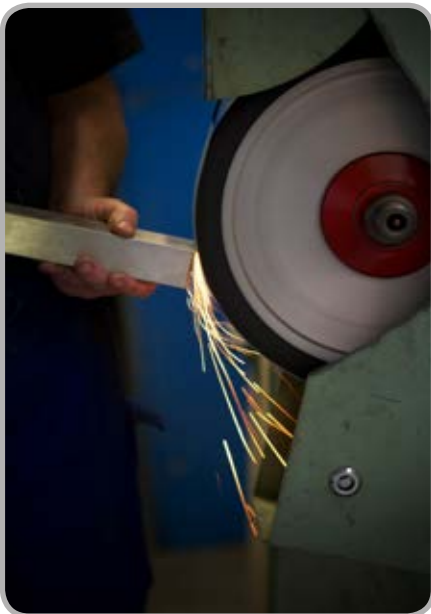

From father to son  
since 1932







**1. Dispensing towers  
Advertising - Taps**

**4-40**

**2. Drainers, driptrays & Sinks  
Counter accessories**

**41-47**

**3. Coolers  
beer-cooler - keg-cooler-bottle-cooler**

**48-56**

**4. Python lines, Cleaning products  
Accessories**

**57-59**

**5. Cleaning & coupling heads/ Pressure regulators**

**60-62**

**6. Party-coolers**

**63-71**

**7. Ice machines**

**72**



Quadro wood  
**P. 6**



Quadro 2 wood  
**P. 7**

**NEW**

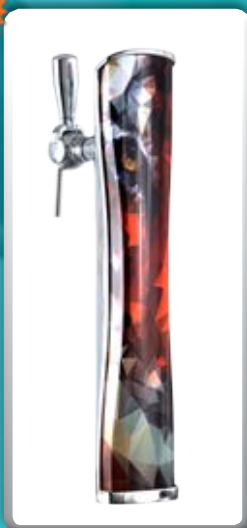

Starled  
**P. 8**



USA  
**P. 9**

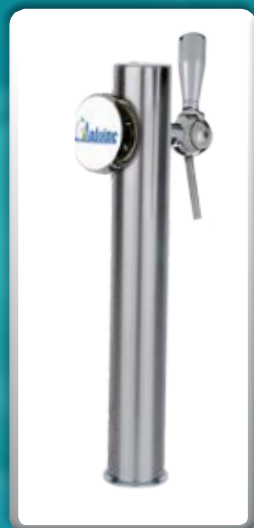

Sphéro  
**P. 10**

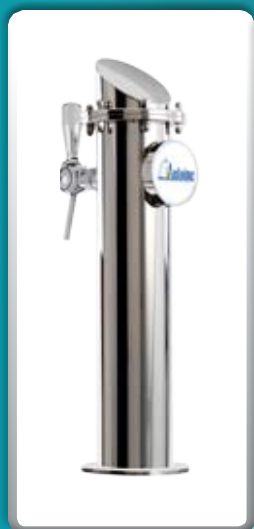

Brisbane  
**P. 11**

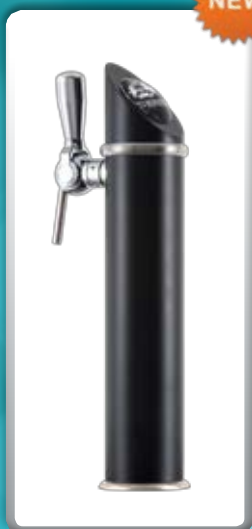

Manhattan  
**P. 12**

**NEW**



Holland  
**P. 13**



Maxima  
**P. 14**



Smash  
**P. 15**



New-Anfo  
**P. 16**



Naja  
**P. 17**

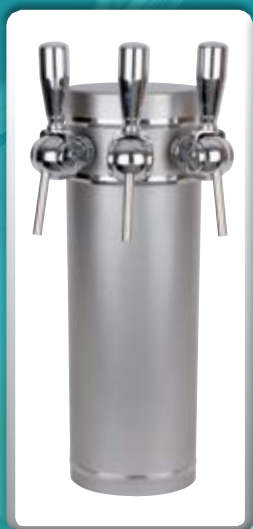

Ellipse vendome  
**P. 18**



Dubai  
**P. 19**



Vogue  
**P. 20-21**

**NEW**



NEW



Dubai-pont  
P. 22



Falcon  
P. 23



Parisienne  
P. 24



Texas  
P. 25



Condor  
P. 26



Smoking  
P. 27



Tropique - Vinci  
P. 28

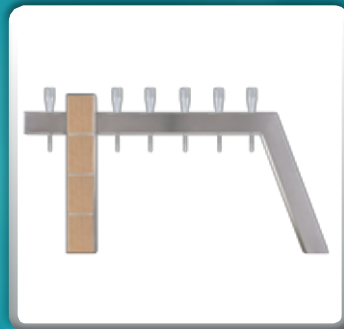

Arcadia  
P. 28



Amazonie  
P. 29



Victoria  
P. 29



Brisbane  
P. 30



Canberra  
P. 31



Melbourne  
P. 31



Oméga  
P. 32



Horizon - Gamma  
P. 33



Delta  
P. 34

# QUADRO WOOD

1 tap



Brushed  
stainless steel  
Wengé  
light oak



Option  
Illumination LED  
Ø 69



Refrigerated



1/2" - 5/8"



Wengé



Light oak

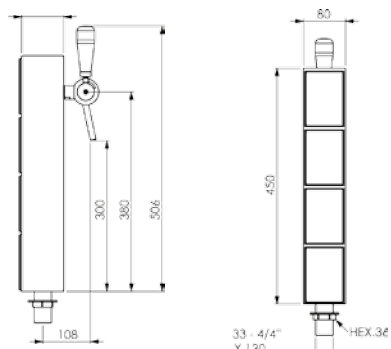

Model : 4 light oak plates



Model : 1 wengé plate



# QUADRO WOOD



Model : 2 Wengé plates



Model : 2 light oak plates

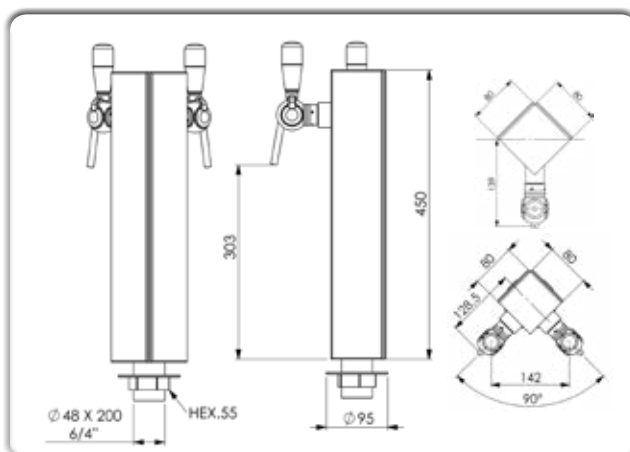
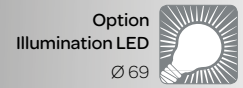

Non-contractual photos

© ANTOINE



# STARLED XL



1 tap



Chromed brass



Illumination LED



Refrigerated



1/2" - 5/8"

## Customise your tower

Send us your logo  
in Adobe Illustrator  
format.

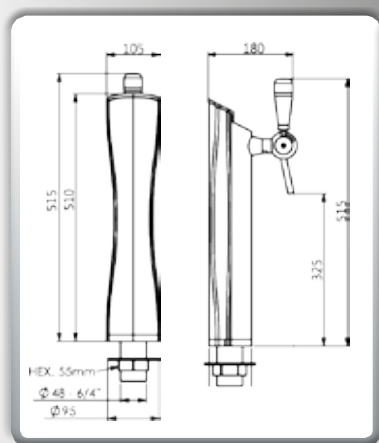



# USA



1 - 2 taps



Chromed brass  
Brushed stainless steel



Option  
Illumination LED  
Ø 69 - Ø 82



Refrigerated



1/2" - 5/8"

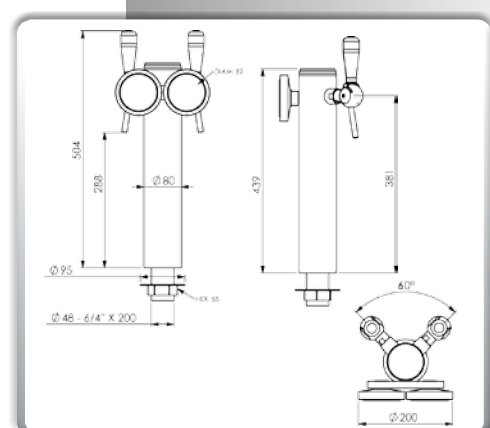

TOWERS

# SPHÉRO 60

1 tap



Brushed  
Stainless steel



Option  
Illumination LED  
Ø 69 - Ø 82



Refrigerated



1/2" - 5/8"



**NEW**

Ivory  
(RAL9001)

**NEW**

ANTHRACITE  
(RAL 9004)

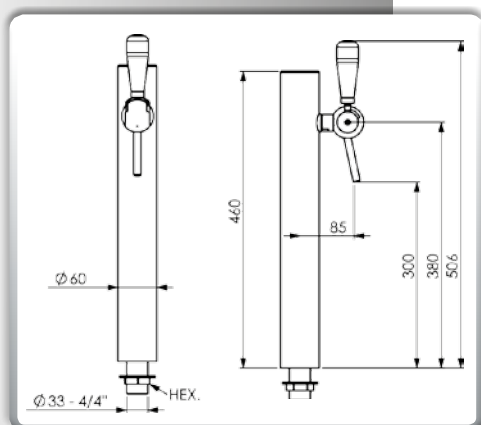



# BRISBANE



1 - 2 taps



Polished stainless steel  
Brushed stainless steel



Option  
Illumination LED  
Ø 69 - Ø 82



Refrigerated



1/2" - 5/8"

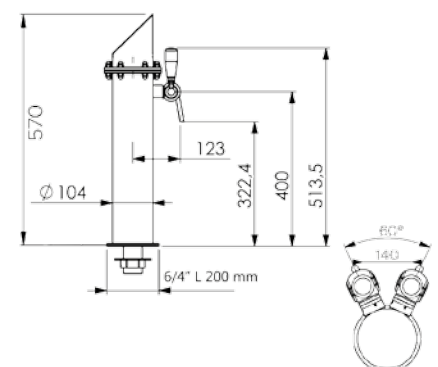

# TOP LIGHT



1 - 2 taps



Brushed stainless steel



Option (max 1)  
LED Illumination



Refrigerated



1/2" - 5/8"



Illumination LED



NEW

ANTHRACITE  
(RAL 9004)

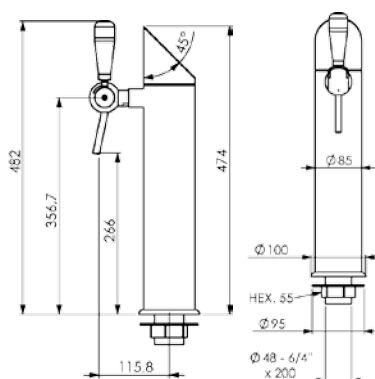



# HOLLAND



1 - 2 taps



Chromed brass  
Polished brass



Option  
Illumination LED  
Ø 69 - Ø 82



Refrigerated



1/2" - 5/8"



Avec 2 robinets  
Met 2 kranen



Avec illumination Ø 69  
Met verlichting Ø 69

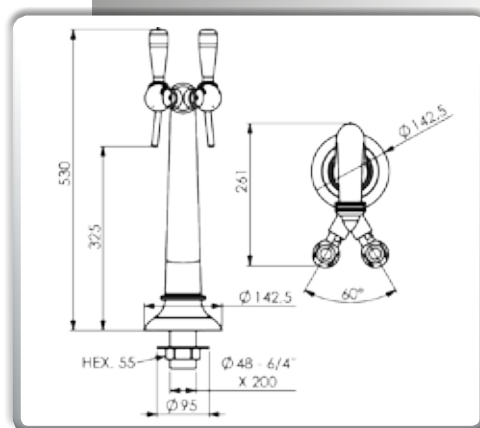

# MAXIMA

1 - 2 taps



Chromed brass



Illumination LED

Ø 69 - Ø 82



Refrigerated  
Condensed  
head of tower



1/2" - 5/8"

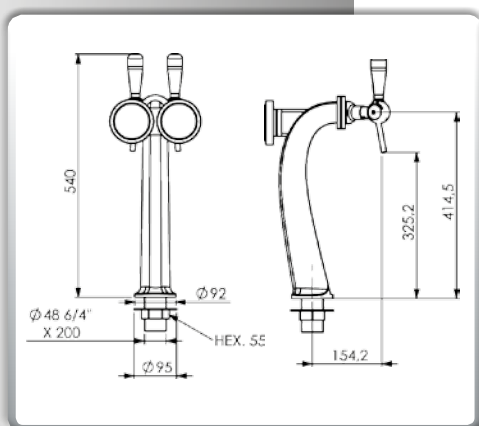

# SMASH



NEW



ANTHRACITE  
(RAL 9004)



IVORY  
(RAL9001)



1 - 2 taps



Chromed  
Ivory



Option (max 1)  
Illumination LED



refrigerated



1/2" - 5/8"

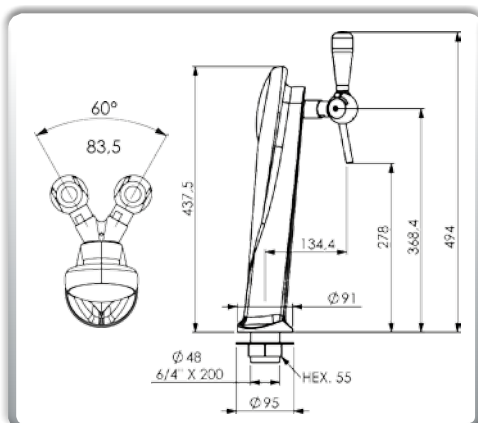



# NEW ANFO

1-2 taps



Chromed  
Black pearl



Option  
Illumination LED



Ø 69 - Ø 82

refrigerated



1/2" - 5/8"



NEW

Black pearl

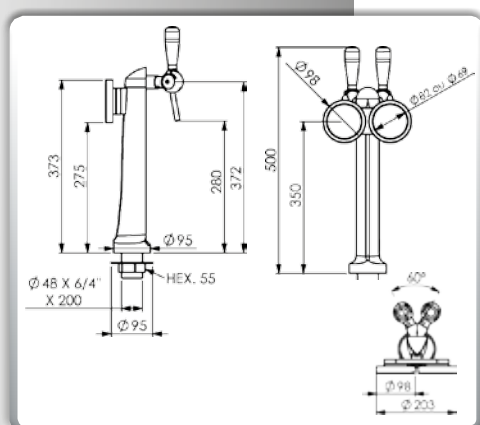



ANTHRACITE  
(RAL 9004)



1 - 4 taps



Chromed



Not illuminated



Refrigerated



1/2" - 5/8"

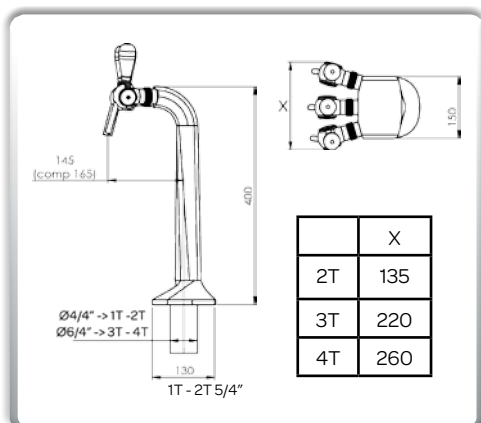

Italian red

# ELLIPSE VENDÔME

1 - 4 taps



Sandblasted  
stainless steel



Option  
Illumination LED  
2 max Ø69 - Ø82



Refrigerated



1/2" - 5/8"

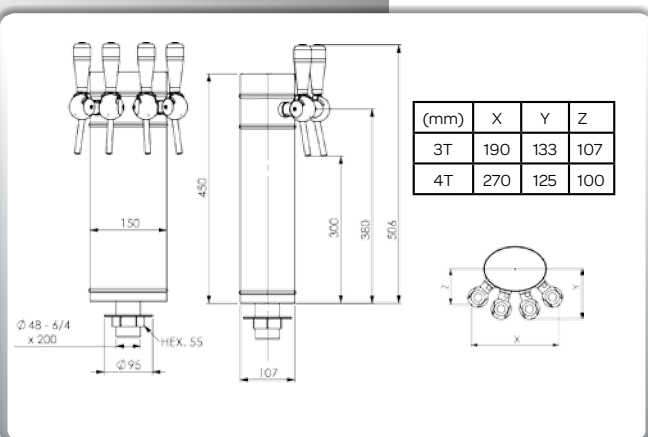



# DUBAi



TOWERS

# VOGUE



3 - 5 taps  
right foot standard  
left foot on request



brushed and polished  
other finish on request



OPTION ILL.  
LED Ø69 - 82



refrigerated



1/2" - 5/8"





On request - Anthracite

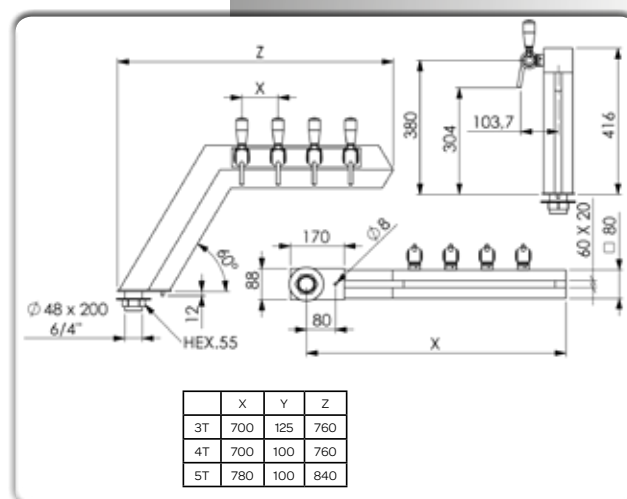
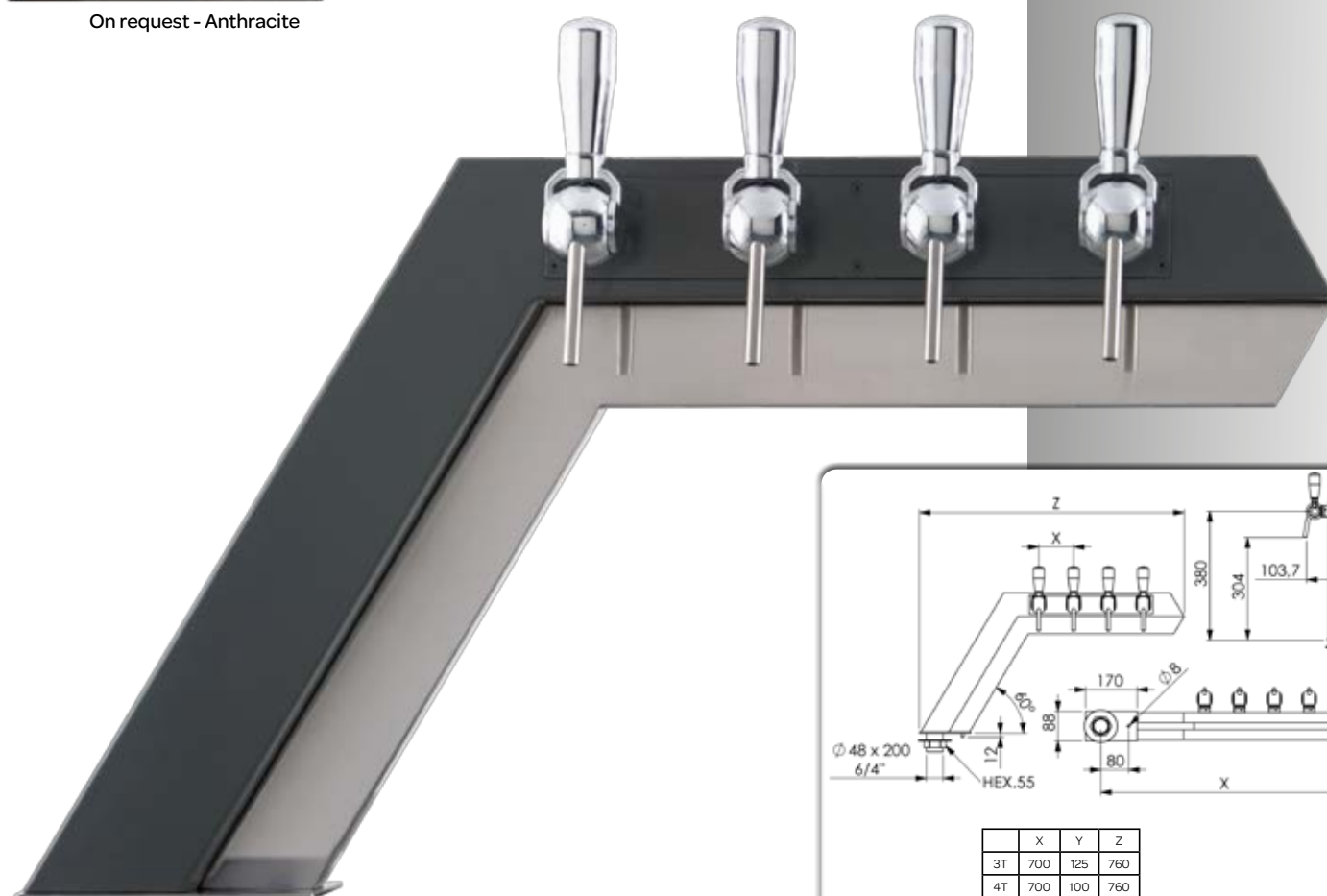



# DUBAÏ - PONT



8 -10 taps



Brushed stainless steel



Illumination LED  
RGB : arm + top



Option  
Illumination  
LED Ø 69 - Ø 82



Refrigerated



1/2" - 5/8"

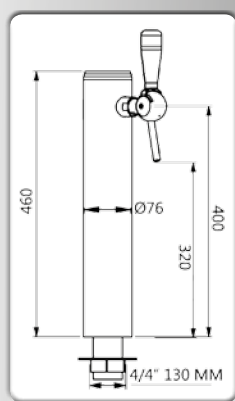
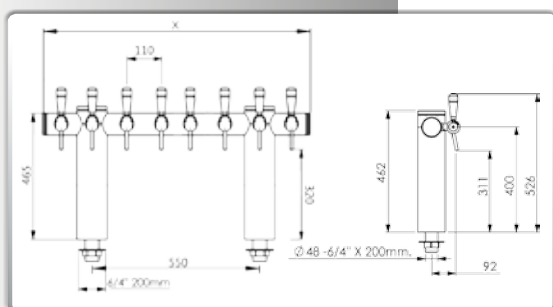

DUBAÏ 1T  
BRUSHED



SMOKING 1T  
ANTHRACITE  
RAL 9004



SMOKING 1T  
IVORY  
RAL9001

# FALCON



3 - 5 taps



Chromed brass  
Pearled chrome  
Gold plated



Option  
Illumination LED  
Ø 69 - Ø 82



Refrigerated



1/2" - 5/8"

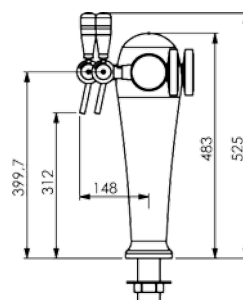

	X	Z
3T		170
5T	136	104

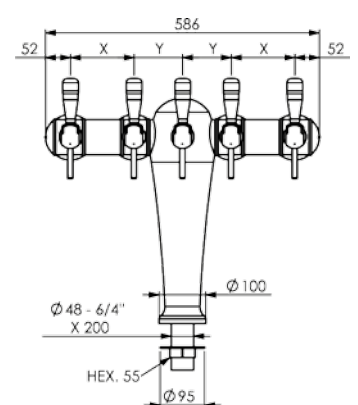

# PARISIENNE



1 - 9 taps



Chromed brass  
Pearled chrome  
Polished brass



Option  
Illumination LED  
Ø 69 - Ø 82



Refrigerated



1/2" - 5/8"

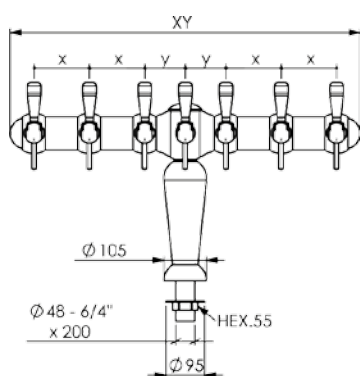
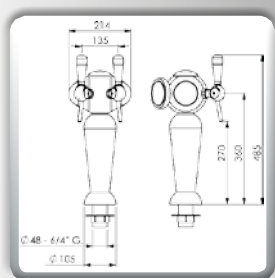

	XY	X	Y
3T	440	160	
5T	600	135	105
7T	875	135	100

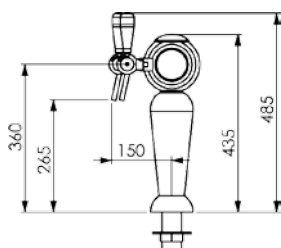



# TEXAS



3 - 5 taps



Polished SS



Option  
Illumination LED  
Ø 69 - Ø 82



Refrigerated



1/2" - 5/8"

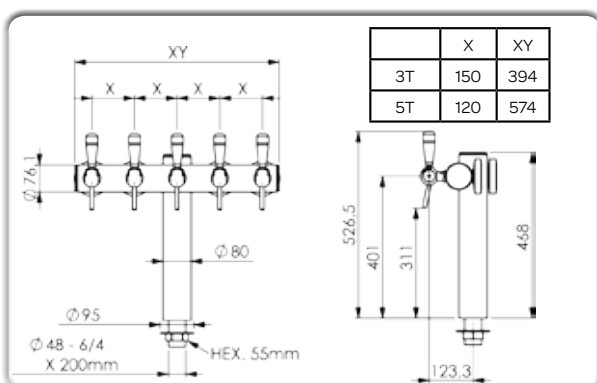

TOWERS

# CONDOR

3 - 5 taps



Chromed brass  
Pearled chrome  
Gold plated



Option  
Illumination LED  
Ø 82



Refrigerated



1/2" - 5/8"

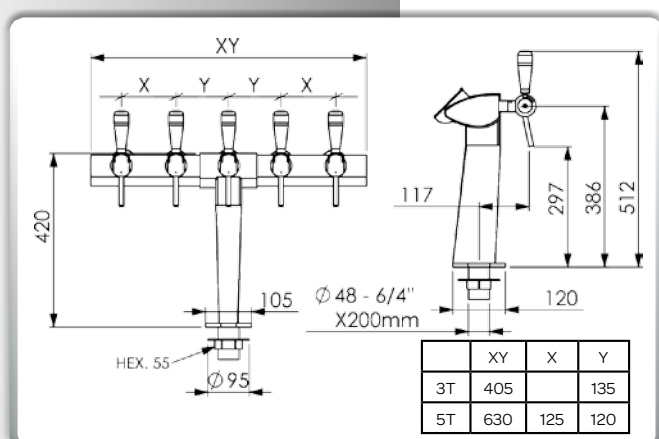



# SMOKING



- 3 - 5 taps
- Ivory Anthracite
- Illumination LED RGB : arm + top
- Option Illumination LED Ø 69 - Ø 82
- Refrigerated
- 1/2" - 5/8"

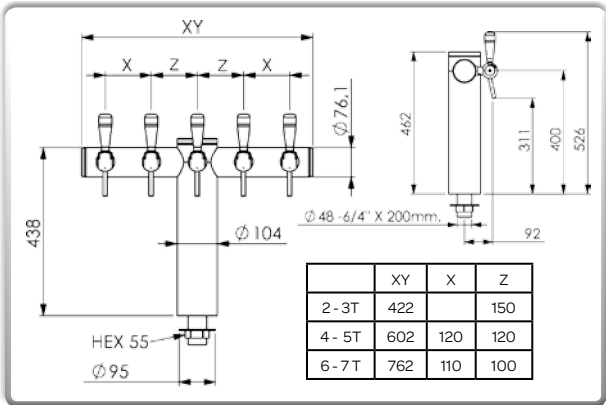

TOWERS

# TROPIQUE

3 - 5 TAPS



Brushed  
WENGÉ OF LIGHT OAK



Option illumination  
LED Ø69 - Ø82



Refrigerated



1/2" - 5/8"

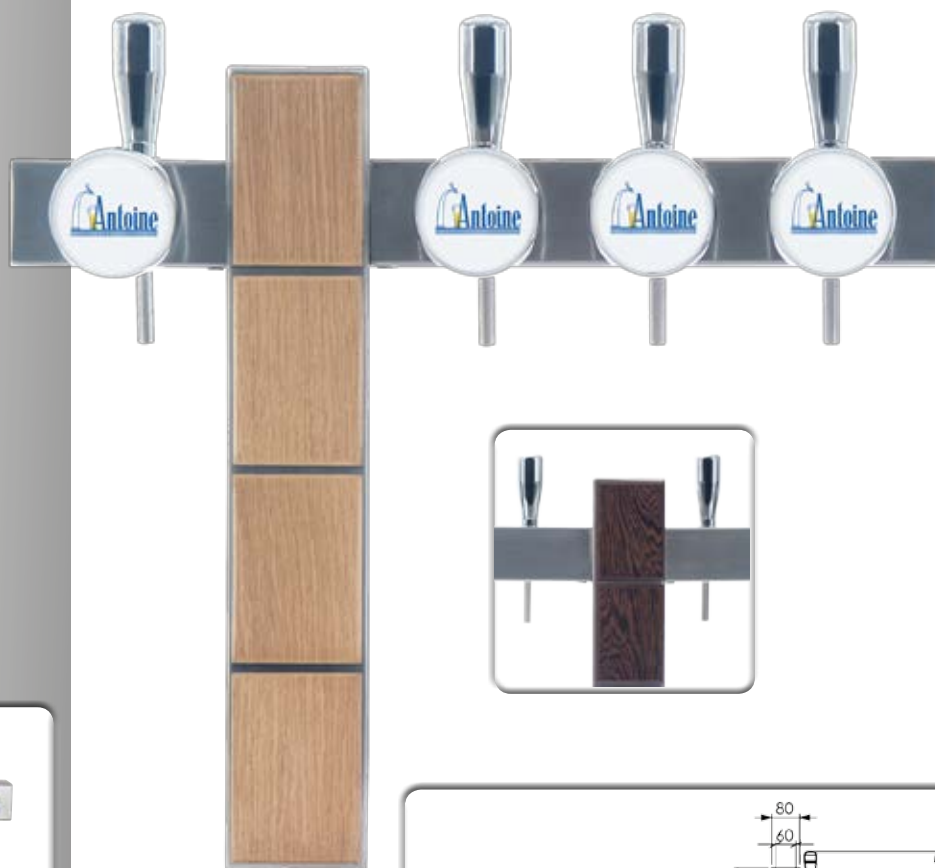

# VINCI

3 - 5 TAPS



model without wood

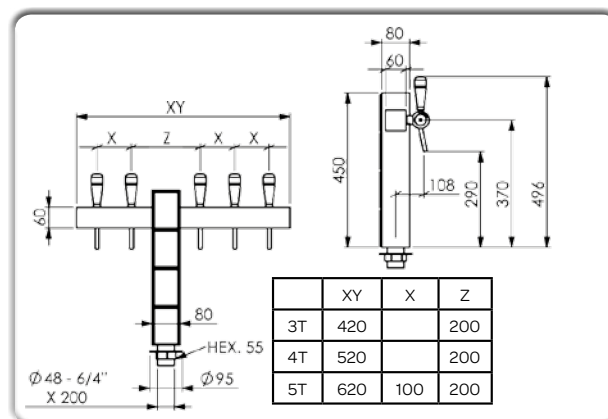

# ARCADIA

4 - 7 TAPS

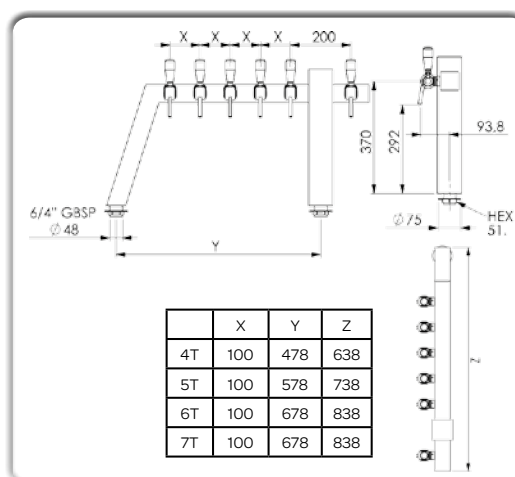
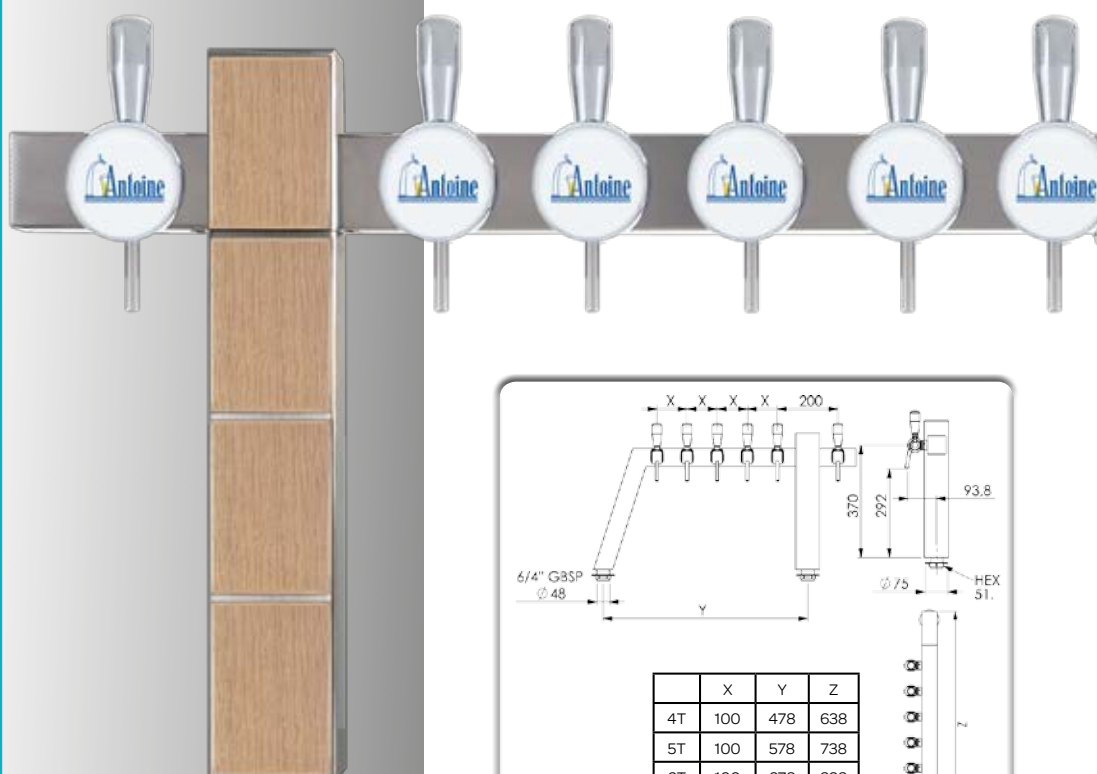



# AMAZONE



6-8 taps



Brushed  
light oak  
Wengé



OPT. ILL.  
LED Ø82 - Ø69



Refrigerated

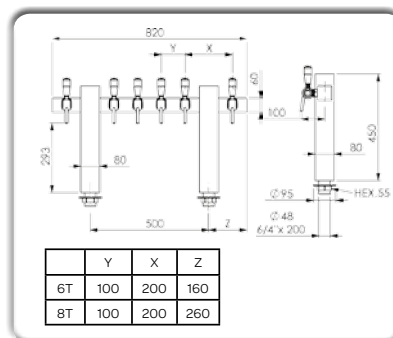

# VICTORIA



4-5-6-8 taps



Brushed



Opt. ILL. Ø82mm



Refrigerated

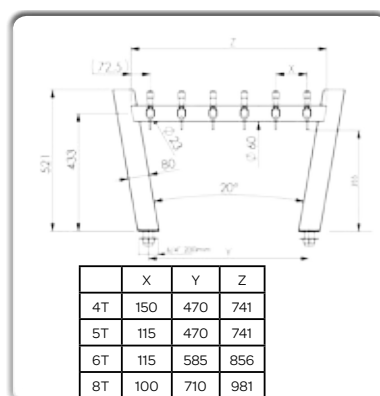

# BRISBANE



4 - 12 taps



Polished stainless steel  
Brushed stainless steel



Option  
Illumination LED  
Ø69 - Ø82



Refrigerated



1/2" - 5/8"

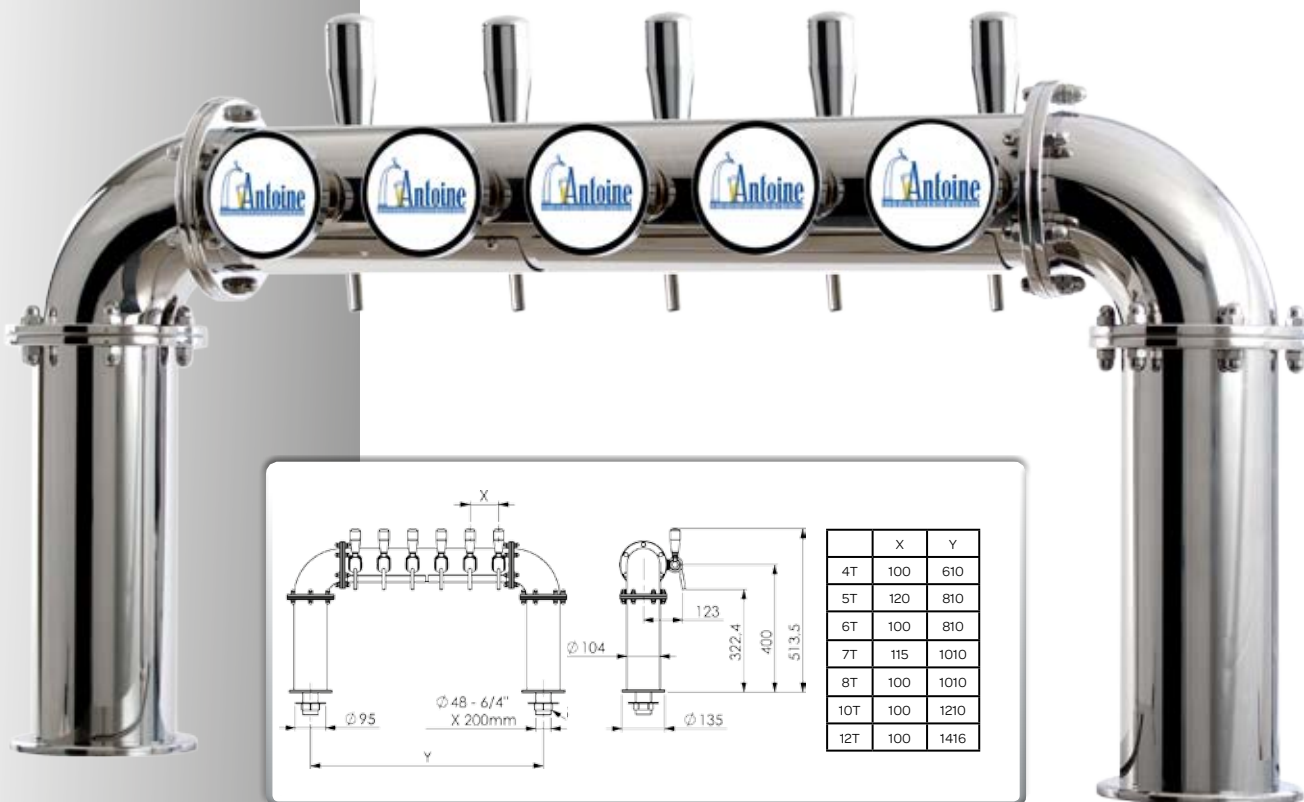

**NEW**



Black finish  
ON REQUEST

# CANBERRA

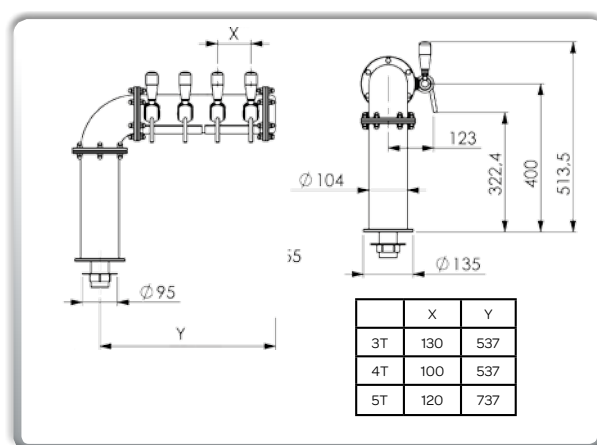
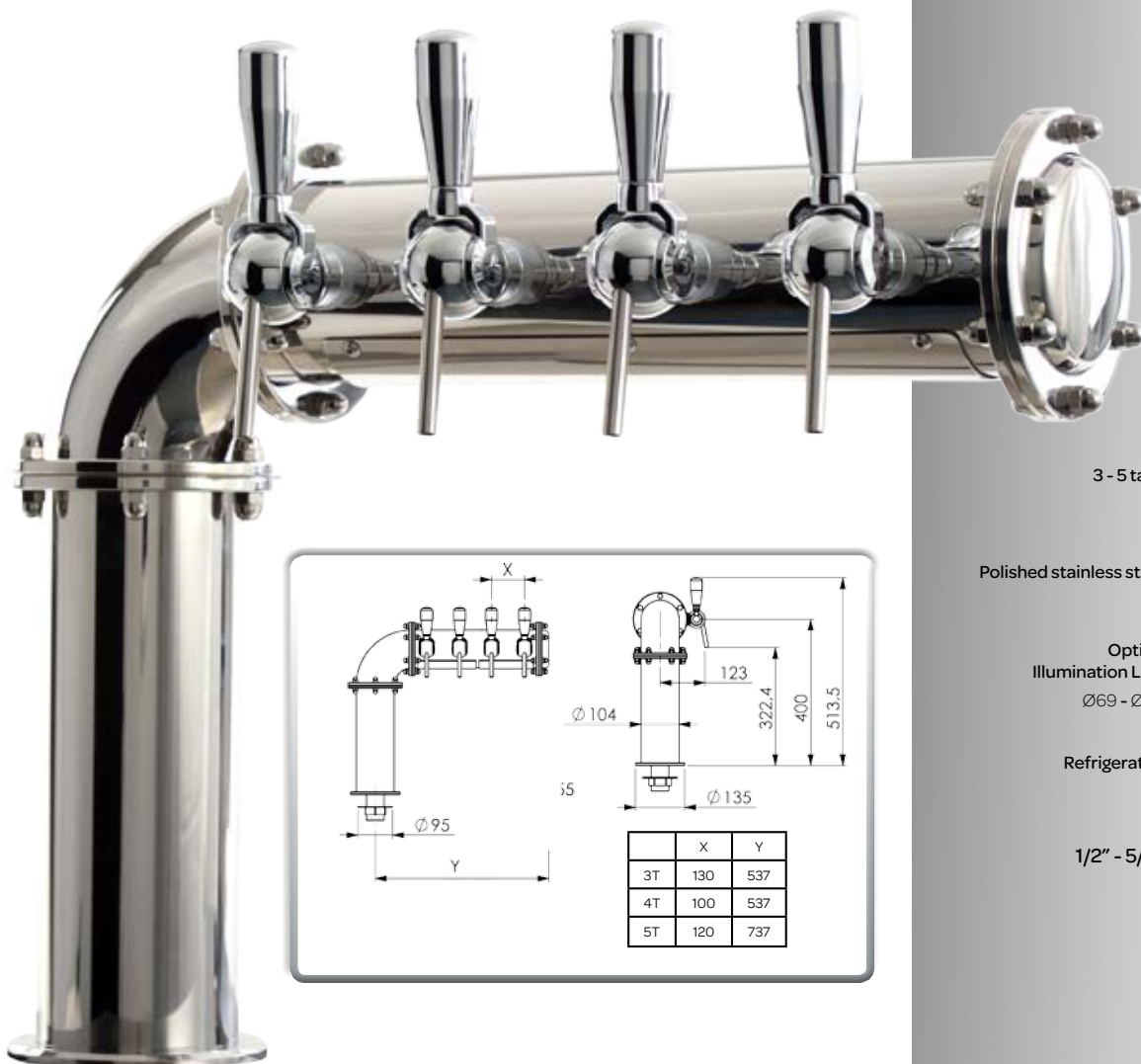

3 - 5 taps



Polished stainless steel



Option  
Illumination LED

$\varnothing 69 - \varnothing 82$



Refrigerated



1/2" - 5/8"



# MELBOURNE

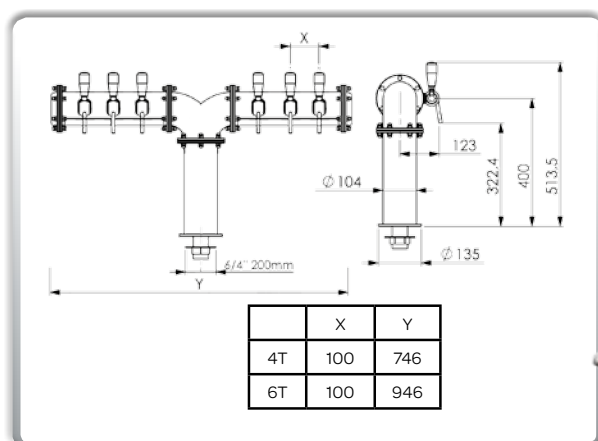
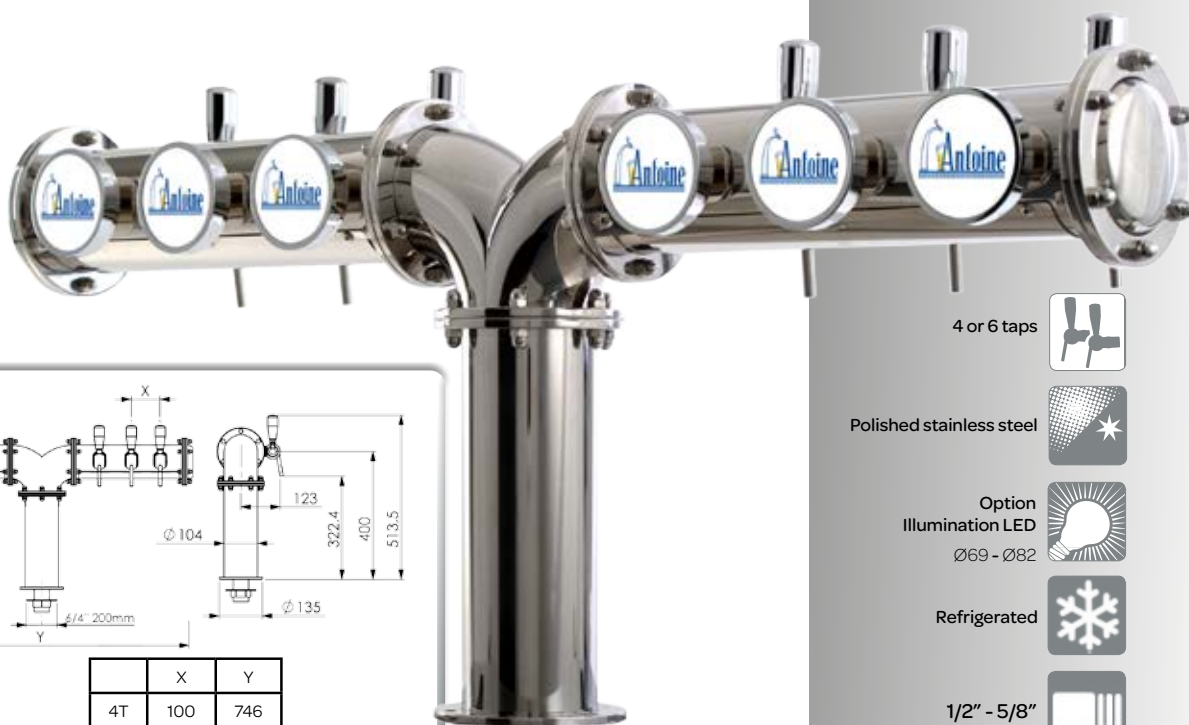

4 or 6 taps



Polished stainless steel



Option  
Illumination LED

$\varnothing 69 - \varnothing 82$



Refrigerated



1/2" - 5/8"



# BI METAL

3 - 10 taps



Brushed with  
polished rings



Option illumination  
LED Ø69 - 82 mm



Refrigerated



1/2" - 5/8"

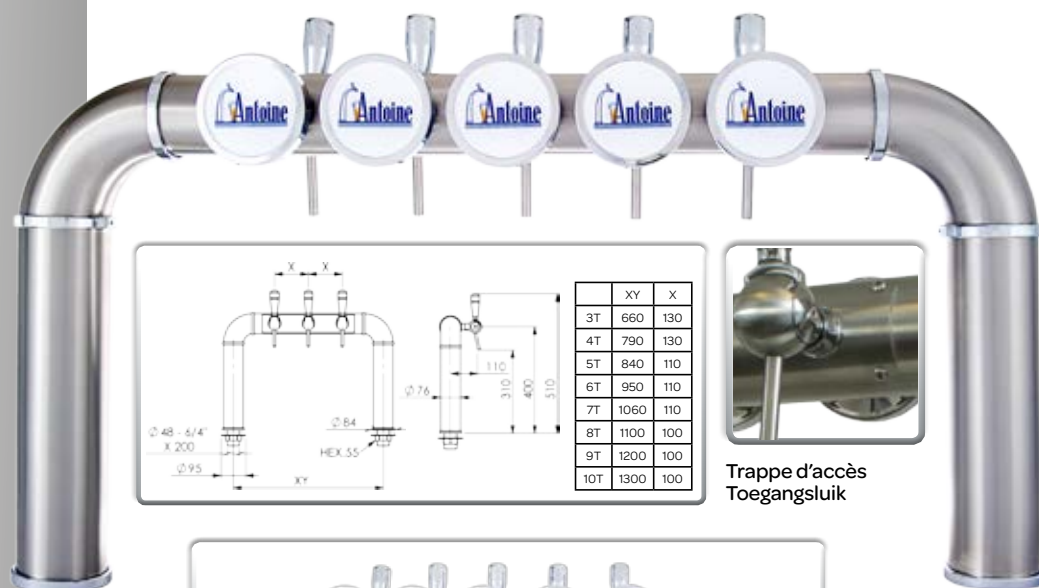

Trappe d'accès  
Toegangsluik



Small foot ON REQUEST

# GAMMA

3 - 5 taps  
reversible



Brushed with  
polished rings



Option illumination  
LED Ø69 - 82 mm



Refrigerated



1/2" - 5/8"





# DELTA SINCENY - ACAJOU



3 - 5 taps



Chromed  
Brass



Option  
LED illumination  
Ø69 - Ø82



Refrigerated



1/2" - 5/8"

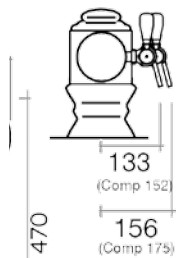
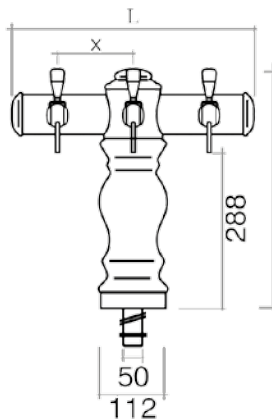
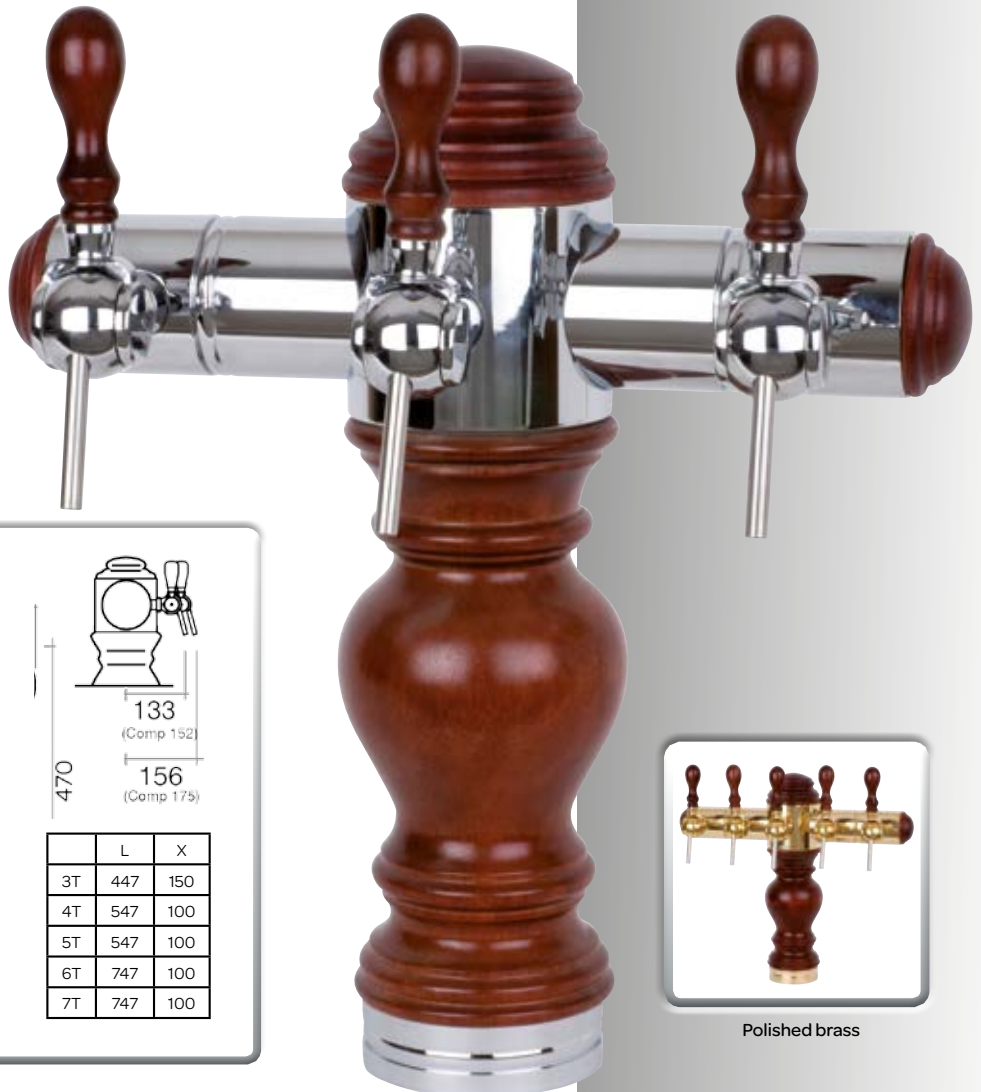

	L	X
3T	447	150
4T	547	100
5T	547	100
6T	747	100
7T	747	100



Polished brass

# AQUA



1 tap



Brushed stainless steel



Not illuminated  
Sticker included



not refrigerated



1/2" - 5/8"



Aqua Quadro

Brushed SS



Aqua Sphéro

Brushed SS

Quadro

Sphéro

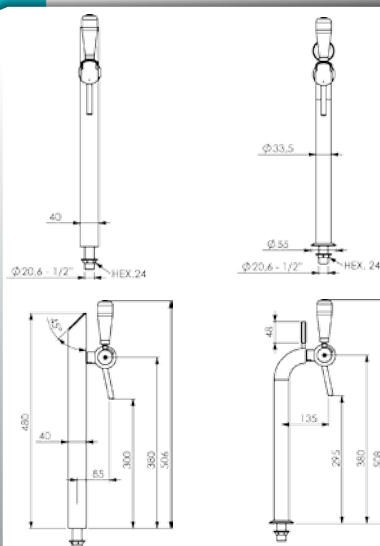

Brisbane - Canon de fusil



Brisbane - Red flame



SPECIALS COLORS



Marco polo "Green"



Marco polo



Black hammered



Plumbing



Rusty



Ellipse black

Plumbing tower



Parisienne bridge



Antique towers

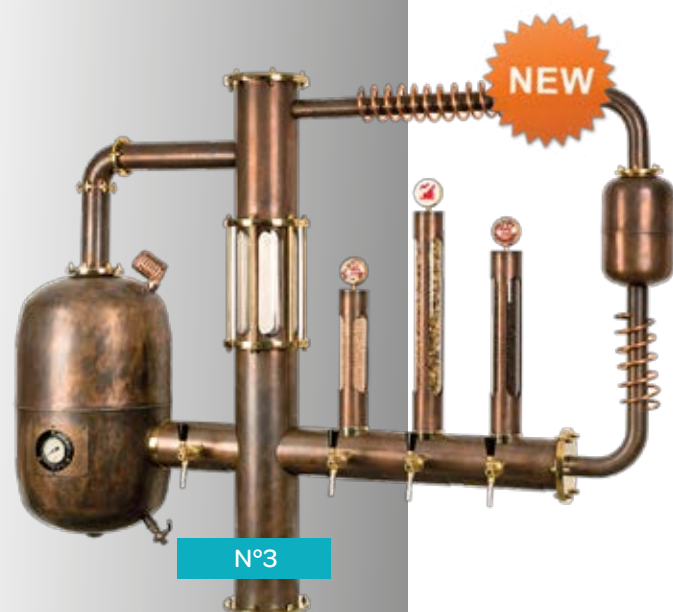
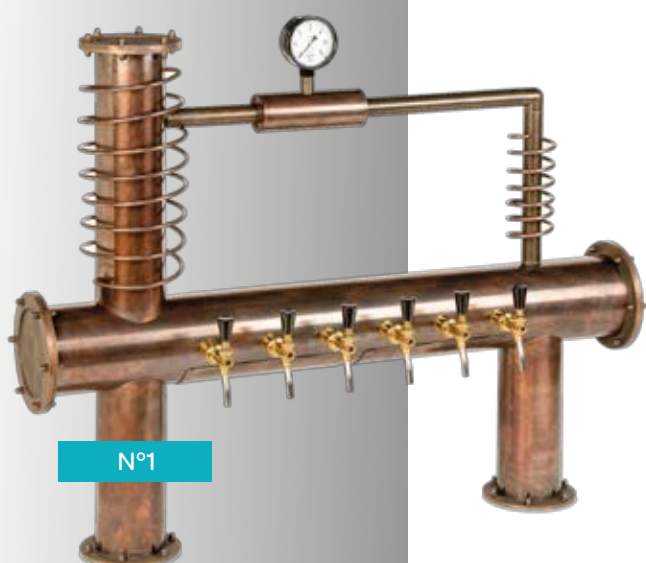



# ADVERTISING

- Round illuminated fish eye lens Ø 69 mm
- Round for illumination pub holder fish eye lens Ø 82 mm
- Round for illumination pub holder flat lens Ø 82 mm



Flat Ø 82



Fish eye Ø69



Fish eye Ø82

Visit our website to discover our customised towers !

## DEBITAP

Reference	Description
171C000*00401	debitap Titanium gold
171C000*00001	debitap polished stainless steel
171C101*55101	debitap polished stainless steel dented rear connexion
171C072*00101	debitap polished stainless steel flare



## DEBITAP SUPERFLOW

Reference	Description
176C000*00006	debitap superflow 12 mm thread 1/2" - 5/8" Titanium gold
176C000*00001	debitap superflow polished stainless steel 12 mm thread 1/2" - 5/8"
ON REQUEST	debitap superflow with foam maker polished stainless steel 12 mm thread 1/2" - 5/8"



## ADAPTOR

Reference	Description
170C400*03000	flare adaptor for nylon (2 pcs)
170C400*02000	flare adaptor for stainless steel (3 pcs)



## REAR CONNECTION

Reference	Rear connection for tap brass or chromed
170C108*00121	12 mm
170C108*00251	25 mm
170C108*00301	30 mm
170C108*00401	40 mm
170C108*00501	50 mm
170C108*00601	60 mm
Rear connections special measures on demand	



## ECOTAP

Reference	Description
173C200*00010	ecotap gold-plated 15 mm thread 1/2" - 5/8"
173C200*00000	ecotap chromed brass 1/2" - 5/8" thread 15, 35, 55 mm Also available in stainless steel



## EVENT-TAP

Reference	Description
175C000*00200	Event - tap 5 mm thread 1/2 JG 3/8



## HANDLES

Reference	Description
184C000*00002	brass handle thread M10
184C000*00001	chromed handle thread M10
181C001*00001	black bakelite handle thread M10
185C000*00001	brushed handle thread M10



## CUSTOMISED HANDLE



Reference	Description
180C100*00000	Customised plastic handle



NEW

Reference	Description	
A3201	Alpha2 1/2" L 13 mm - Ø 8 mm Brass	
A3202	Alpha2 1/2" L 13 mm - Ø 8 mm Chromed brass	
A3101	Alpha2 Dented front for dented rear connection Brass	
A3100	Alpha2 Dented front for dented rear connection Chromed brass	
A3001	Alpha2 compensator 1/2" L 13 mm Brass	
A3000	Alpha2 compensator 1/2" L 13 mm Chromed brass	
A3081	Alpha2 compensator 1/2" L 30 mm - JG 3/8" Brass	
A3080	Alpha2 compensator 1/2" L 30 mm - JG 3/8" Chromed brass	
A4111	Threaded rear connection 10 mm (fixed part + ring) Polished brass	
A4121	Threaded rear connection 22 mm (fixed part + ring) Polished brass	
A4141	Threaded rear connection 30 mm (fixed part + ring) Polished brass	
A4110	Threaded rear connection 10 mm (fixed part + ring) Chromed brass	
A4120	Threaded rear connection 22 mm (fixed part + ring) Chromed brass	
A4140	Threaded rear connection 30 mm (fixed part + ring) Chromed brass	
POIGN001	Alu handle Brass	
POIGN002	Alu handle Chromed	
POIGN003	Alu handle Pearl-chromed	
POIGN004	Alu handle Brushed chrome	

## PUBLICITY HOLDERS

Ref	Description
 186C010*00000 n° 10	Stainless steel Rond: Ø 80 ou 70 mm
 186C009*00000 n° 9	Stainless steel Oval - Vertical Width : 63 mm Height : 75 mm



## 2. Drainers & Sinks

### Counter material



# DRAINERS & DRIPTRAYS

Ref	Dimensions	With perforated plate
204	250 X 400 X 40 mm	1 hole
205	400 X 400 X 40 mm	1 to 2 holes
206	500 X 400 X 40 mm	1 to 2 holes
207	600 X 400 X 40 mm	1 to 3 holes
208	700 X 400 X 40 mm	1 to 4 holes
208C500	1000 X 400 X 40 mm	1 to 5 holes
214	500 X 500 X 50 mm	1 to 2 holes
210	600 X 500 X 50 mm	1 to 3 holes
211	800 X 500 X 50 mm	1 to 4 holes
212	1000 X 500 X 50 mm	1 to 5 holes



Ref	Dimensions	Drainer for glasses with total perforated plate
205C100	400 X 400 mm X 40 mm	
206C100	500 X 400 mm X 40 mm	
207C100	600 X 400 mm X 40 mm	
208C100	700 X 400 mm X 40 mm	
209C100	800 X 400 mm X 40 mm	
213C100	1000 X 400 mm X 40 mm	



Ref	Dimensions	Drip trays with perforated plate
219C001	300 X 180 X 30 mm	
220	400 X 180 X 30 mm	
221	730 X 150 X 30 mm	



Ref	Dimensions	Drainers for glasses
230	500 X 500 X 50 mm	
231	600 X 500 X 50 mm	
232	700 X 500 X 50 mm	
233	800 X 500 X 50 mm	
234	1000 X 500 X 50 mm	



Ref	Dimensions	Drainers for towers Half-lined models
		With discharge
235	600 X 500 X 50 mm	1 to 3 holes
236	700 X 500 X 50 mm	1 to 3 holes
237	800 X 500 X 50 mm	1 to 4 holes
238	1000 X 500 X 50 mm	1 to 5 holes
239	1200 X 500 X 50 mm	1 to 5 holes



# DRAINERS & SINKS

Ref.	Width x depth x height	
255C000*1	800 x 500 x 50 mm, equipped with : 2 sinks of 290 X 350 mm 2 funnels	
256C000*1	1000 x 500 x 50 mm, equipped with : 2 sinks of 290 X 350 mm (left, right or middle) 2 funnels	
257C000*1	1200 x 500 x 50 mm, equipped with : 2 sinks of 290 X 350 cm (left, right or middle) 2 funnels	

Funnels included

OPTION  
Combined discharge  
Syphon  
Watertap  
Glass rinser

Depth sink: 220 mm

## Half lined

## Half perforated plate

258C150*1	1500 x 500 x 50 mm, equipped with: 2 sinks of 290 X 350 mm (left, right or middle) drainer half lined 1 to 5 holes 2 funnels	258C150*0	1500 x 500 x 50 mm, equipped with: 2 sinks of 290 X 350 mm (left, right or middle) drainer half perforated plate 1 to 5 holes 2 funnels
259C100	2000 x 500 x 50 mm, equipped with: 2 sinks of 29 x 35 cm (left or right) drainer half lined 0 to 5 holes 2 funnels	250C000	2000 x 500 x 50 mm, equipped with: 2 sinks of 290 x 350 mm (left or right) drainer half perforated plate 0 to 5 holes 2 funnels
259C500	2500 x 500 x 50 mm, equipped with: 2 sinks of 290 x 350 mm (left or right) drainer half lined 0 to 5 holes 2 funnels	259C400	2500 x 500 x 50 mm, equipped with: 2 sinks of 290 x 350 mm (left or right) drainer half perforated plate 0 to 5 holes 2 funnels
225C00*00001	Supplement for glass-rincer		



# CUSTOM MADE DRAINERS

## Description

### Custom made drainer



### Base for drainer



### Special pieces



### Custom made



## Clamps

N°1



N°3



\*Customised clamps are available on demand (DUOCLAMS,...)



# ACCESSORIES & CLEANING PRODUCTS

Ref.	Description		
263	<b>Funnels</b>	6/4	4/4
			
264	<b>Watertap cold</b>		
265	<b>Watertap cold &amp; warm</b>		
266	<b>Brush for glasses</b>		
267 OUT*PRO	<b>Becharein</b> <b>Maintenance / Protal for fonts</b>		
268	<b>Combined discharge</b>		
269	<b>Syphon</b>		
			
271	<b>Foam-cutter</b>		
272	<b>Stainless steel cup for foam-cutter</b>		
			
171CBOU	<b>Pear for cleaning outlet tap</b>		

# LAVAMATIC & ACCESSORIES

Ref.	Description
274C000*00000	<b>Lavamatic Standard 27</b> - (H267 x W365 x L180 mm)



- Lavamatic Standard 27**  
Water connection to confirm :
- Gardena
  - Thread 3/8"
  - Thread 1/2"

Description
<b>Box of cleaning tablets (600 gr)</b> - Hydromatic
<b>Lavamatic built-in drainer (H282 x W400 x L250 mm)</b>



Description
<b>Glass rinser for drainers - Ø 102 mm</b>
225C000*00501
<ul style="list-style-type: none"> <li>• New design that prevents and minimising risk of bacterial transfer.</li> <li>• with water pipe</li> </ul>



6/4"



### 3. Coolers



# Beer-cooler “Reversible” BANCO



- Reversible (Horizontal)
- Adjustable water tank and ice bank
- Frame in skinplate



(not reversible)



(not reversible)

Model	Banco 14 L
Reference :	407C
Compressor :	1/5 HP
Power consumption:	0°C = 216 W - -10°C = 182 W
Cooling capacity :	0°C = 447 W - -10°C = 290 W
Number of coils max :	1 x 20 m or 2 x 15 m
Water tank :	14 L
Ice bank :	4 kg
Dimension mm (WxDxH) :	(325x300x665)
Weight:	20,5 kg

Model	Banco 40 L
Reference :	412C
Compressor :	1/4 HP
Power consumption:	0°C = 270 W - -10°C = 228 W
Cooling capacity :	0°C = 559 W - -10°C = 364 W
Number of coils max :	2 x 20 M + 1 x 10 M
Water tank :	40 L
Ice bank :	18 kg
Dimension mm (WxDxH):	
Vertical :	(405x445x735)
Horizontal :	(750x445x475)
Weight:	28 kg

Model	Banco 60 L
Reference :	415C
Compressor :	1/3 HP
Power consumption:	0°C = 360 W - -10°C = 303 W
Cooling capacity :	0°C = 745 W - -10°C = 485 W
Number of coils max :	3 x 25 M + 1 x 10 M
Water tank :	60 L
Ice bank :	30 kg
Dimension mm (WxDxH):	
Vertical :	(485x485x860)
Horizontal :	(805x505x510)
Weight:	42 kg

Model	Banco 90 L
Reference :	422C
Compressor :	1/2 HP
Power consumption:	0°C = 540 W - -10°C = 455 W
Cooling capacity :	0°C = 1118 W - -10°C = 727 W
Number of coils max :	5 x 25 M + 1 x 10 M
Water tank :	90 L
Ice bank :	45 kg
Dimension mm (WxDxH):	
Vertical :	(585x595x915)
Horizontal :	(950x595x610)
Weight:	52 kg

Model	Banco 144 L
Reference :	432C
Compressor :	3/4 HP
Power consumption:	0°C = 810 W - -10°C = 682 W
Cooling capacity :	0°C = 1677 W - -10°C = 1090 W
Number of coils max :	10 x 25 M + 2 x 10 M
Water tank :	144 L
Ice bank :	75 kg
Dimension mm (WxDxH):	(1230x555x595)
Weight:	59 kg



# BEER-COOLER COMPACT

NEW

Modèle	25 L	90 L	140 L
Compressor :	1/4 CV	1/2 CV	1 HP
Power consumption:	0°C = 270 W -10°C = 228 W	0°C = 540 W -10°C = 455 W	0°C = 1080 W -10°C = 910 W
Cooling capacity :	0°C = 559 W -10°C = 364 W	0°C = 1118 W -10°C = 727 W	0°C = 2236 W -10°C = 1454 W
Ice bank :	8 kg	45 kg	75 kg
Water tank :	25 L	90 L	144 L
Number of coils max. :	2 X 18 M + 1 X 10 M	4 X 22 M + 1 X 10 M	10 x 25 M + 2 x 10 M
Dimension mm (WxDxH) :	(535x340x590)	(775x510x620)	(860 X 580 X 900 (vertical))
Weight :	28 kg	46 kg	65 kg



## WATERBATH

Modèle	60 L	90 L	144 L
Compressor not included :	1/3 HP	1/2 HP	3/4 or 1 HP
Power consumption:	à 0°C = 315 W à -10°C = 265 W	à 0°C = 540 W à -10°C = 455 W	à 0°C = 810 W à -10°C = 682 W
Cooling capacity :	à 0°C = 730 W à -10°C = 475 W	à 0°C = 1118 W à -10°C = 727 W	à 0°C = 1600 W à -10°C = 1000 W
Ice bank :	30 kg	40 kg	75 kg
Number of coils max. :	3x22m + 1x10m	5x22m + 1x10m	10x25 + 2x10
Water tank :	60 L	90 L	144 L
Dimension mm (WxDxH) :	(540x465x595)	(625x55x590)	(940x550x590)
Weight :	19 kg	24 kg	32 kg



## PUMPS & AGITATORS

Reference	
666C000*00000	Agitator 1500 T/M
661C000*00300	Agitator 2500 T/M
656C000*P1407	Circulation pump - height mano. 7 m - 30 W - 0,14 A
658C000*P1312	Circulation pump - height mano. 12 m - 60 W - 0,27 A
658C000*P1320	Circulation pump - height mano. 18 m - 90 W - 0,41 A
659C000*00023	Circulation pump - height mano. 23 m - 90 W - 0,41 A

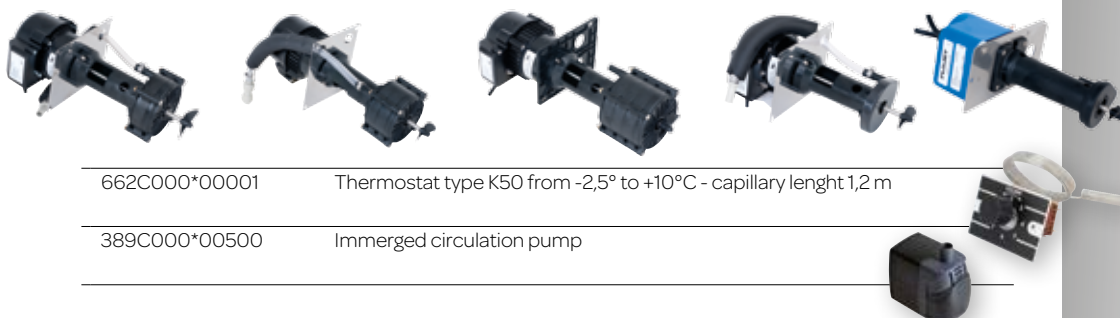

662C000*00001	Thermostat type K50 from -2,5° to +10°C - capillary lenght 1,2 m
389C000*00500	Immerged circulation pump



BEER-COOLERS

## Cooled kegs draft system

**creative,  
works  
because  
it's simple**

The cooled keg draft system is a modern and simple way to draft beers with a lot of advantages.



### Hygiene

The risk of infection is limited because the temperature of all parts is kept between 2 and 4 ° C.

Limited risk of supersaturation.



### Savings

No loss of beer.

Rinsing with water is not required between each keg.

30% energy saving.

40% less CO2 consumption.



### Long life

The keg can remain open for 3 weeks without altering the taste of the beer.



### Maintenance

Very easy to maintain, sanitation is limited compared to a conventional installation.

Removable refrigeration unit.

# Cooled kegs draft system

## Cooled kegs draft system



# KEG - COOLERS

Ref.	Description	
524C001*05500A	<b>2 X 20 L</b> For 2 kegs Dimensions (W x D x H) 620 x 575 x 820/860 mm 2 kegs of 20 L Built-in monobloc Finish: grey anthracite Power : 345 W Cooling gas : R290	
524C001*08800A	<b>4 X 20 L * 1 X 30 L * 1 X 50 L</b> For 4 kegs External dimensions (W x D x H) 880 X 590 X 820/860 mm Internal dimensions 500 X 500 X 765 mm Built-in monobloc Finish: grey anthracite Power : 345 W Cooling gas : R290	
524C001*11100A	<b>6 X 20 L * 1 X 30 L * 1 X 50 L</b> For 6 kegs External dimensions (W x D x H) 1110 X 590 X 820/860 mm Internal dimensions 730 X 500 X 765 mm Built-in monobloc Finish: grey anthracite Power : 345 W Cooling gas : R290	
524C001*13500A	<b>8 X 20 L * 2 X 30 L * 2 X 50 L</b> For 8 kegs External dimensions (W x D x H) 1350 X 590 X 820/860 mm Internal dimensions 970 X 500 X 765 mm Built-in monobloc Finish: grey anthracite Power : 345 W Cooling gas : R290	



REMOVABLE MONOBLOC

## FOR 1 TAP

Reference	Description
<b>524C001*05500A</b>	<b>1 keg-cooler 2X20L (LXDXH): 620 x 590 x 820/880 mm</b>
<b>On choice</b>	1 tower 1 tap
<b>On choice</b>	1 drainer L max. 620 mm
302C000*01500	1 pressure regulator 2 levels 1,5 bars
<b>On choice</b>	1 coupling head A or S with elbow valve
524C100*00001	1 accessories kit
524C000*VEN01	1 Fanset for keg-cooler
524C100*00004	1 complete assembly in workshop
	<b>In option :</b>
524C001*ROU01	Mobile : 4 wheels Ø 125 mm (2 with brakes)



## FOR 2 TAPS

Référence	Description
<b>524C001*08800A</b>	<b>keg-cooler 4X20L (LXDXH): 880 x 590 x 820/880 mm</b>
<b>On choice</b>	1 tower 2 taps
<b>On choice</b>	1 drainer L max. 880 mm
302C000*01500	1 pressure regulator 2 levels 1,5 bars
<b>On choice</b>	2 coupling heads A ou S with elbow valve
524C100*00001	1 accessories kit
524C000*VEN01	1 Fanset for keg-cooler
524C100*00004	1 complete assembly in workshop
	<b>In option :</b>
524C001*ROU01	Mobile : 4 wheels Ø 125 mm (2 with brakes)



## FOR 3 TAPS

Référence	Description
<b>On choice</b>	<b>keg-cooler 6X20L (LXDXH): 1110 x 590 x 820/880 mm</b>
<b>On choice</b>	1 tower 3 taps
<b>On choice</b>	1 drainer L max. 1100 mm
302C000*01500	1 pressure regulator 2 levels 1,5 bars
<b>On choice</b>	3 coupling heads A or S with elbow valve
524C100*00001	1 accessories kit
524C000*VEN01	1 Fanset for keg-cooler
524C100*00005	1 complete assembly in workshop
	<b>In option :</b>
524C001*ROU01	Mobile : 4 wheels Ø 125 mm (2 with brakes)



## FOR 4 TAPS

Référence	Description
<b>On choice</b>	<b>keg-cooler 8X20L (LXDXH): 1350 x 590 x 820/880 mm</b>
<b>On choice</b>	1 tower 4 taps
<b>On choice</b>	1 drainer L max. 1350 mm
302C000*01500	1 pressure regulator 2 levels 1,5 bars
<b>On choice</b>	4 coupling heads A or S with elbow valve
524C100*00001	1 accessories kit
524C000*VEN01	1 Fanset for keg-cooler
524C100*00005	1 complete assembly in workshop
	<b>In option :</b>
524C001*ROU01	Mobile : 4 wheels Ø 125 mm (2 with brakes)





# Bottle-coolers VISION

Description				
Reference :	775C000*00010	774C000*00010	773C000*00010	
LED illumination	Yes	Yes	Yes	
Dimensions:	Dimensions: 600x500x900	900x500x900	1350x500x900 mm	
Bottle capacity:	105 bottles of 33 cl	180 bottles of 33 cl	325 bottles of 33 cl	
Volume:	150 L	250 L	315 L	
Interior finish:	silverskinplate	silverskinplate	silverskinplate	
Exterior finish:	anthracite skinplate	anthracite skinplate	anthracite skinplate	
Capacity:	210 W - 1/5 HP - 220/240 V - 50 Hz	230 W - 1/5 HP - 220/240 V - 50 Hz	260 W - 1/4 HP - 220/240 V - 50 Hz	
Adjustable thermostat:	+2°C/+10°C	+2°C/+10°C	+2°C/+10°C	
Refrigerant gas :	R600	R600	R600	
Automatic defrost	Yes	Yes	Yes	
Lock	Yes	Yes	Yes	
Netto weight:	Netto weight 50 KG	Netto weight 60 KG	100 KG	
	Door opening only to the right	774C000*0020 / With 2 sliding doors	773C000*0020 / With 3 sliding doors	



## Description

Ref.: 777C200\*00010

Bottle capacity: 372 L - 275 BT  
Capacity : 1/4 HP – 525W  
Dimensions (W x D x H) : 595 x 600 x 1980 mm  
Weight : 89 kg  
Cooling gas : R600  
Adjustable thermostat: 1° C à 10° C  
with advertising top



## Description

Ref.: 777C300\*00010

Bottle capacity: 375 L - 275 BT  
Capacity : 1/4 HP – 525W  
Dimensions (W x D x H) : 595 x 600 x 1840 mm  
Weight : 86 kg  
Cooling gas : R600  
Adjustable thermostat: : +1°C / +10°C  
ref : 777C300\*CH010  
Structure on wheels for vision coolers



# Bottle coolers **BAHUT**

Ref.

Description

780C000\*00000

Bottle cooler "Bahut" standard  
Dimensions (WxDxH): 1030 x 620 x 1015 mm  
2 sliding covers  
Volume : 257 Liters  
Standard wheels



780C000\*00002

Bottle cooler "Bahut"  
Dimensions (WxDxH): 1030 x 620 x 1065 mm  
2 sliding covers  
Volume : 257 Liters  
Big wheels diameter 100 mm



780C000\*00001

Bottle cooler "Bahut" Fortified  
Dimensions (WxDxH): 1030 x 620 x 1065 mm  
2 sliding covers  
Volume : 257 Liters  
With protection  
Big wheels diameter 100 mm



780C000\*CHA10

Transport structure in stainless steel







On demand  
minimum quantity 50 pc

# BOTTLE - COOLERS

## with built-in cooling unit- FULL DOORS

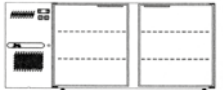

- 2 shelves per door
- 3 storage levels
- LED lights
- Cooling unit on left side or right

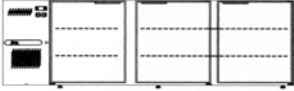
	Ref.	LxDxH	Doors Lenght	Number of bottles 25 cl	Cooling capacity	Weight
	9000C 1240*	1240 mm 550 mm 820 mm	2  390 mm (#) 395 mm	273	525 W 1/4 HP R134 a 220 V-2,7 A	84 kg
	9000C 1350*	1350 mm 550 mm 820 mm	2  455 mm	301	525 W 1/4 HP R134 a 220 V-2,7 A	88 kg
	9000C 1540*	1530 mm 1540 mm 550 mm 820 mm	2  455 mm (#) 525 mm	373	525 W 1/4 HP R134 a 220 V-2,7 A	94 kg
	9000C 1740*	1740 mm 550 mm 820 mm	3  330 mm (#) 395 mm	440	525 W 1/4 HP R 134 a 220 V-2,7 A	104 kg
	9000C 1880*	1875 mm 1880 mm 550 mm 820 mm	3  455 mm (#) 440 mm	485	700 W 1/3 HP R134 a 220 V-3,4 A	108 kg
	9000C 2140*	2140 mm 550 mm 820 mm	3  540 mm (#) 525 mm	570	700 W 1/3 HP R134 a 220 V-3,4 A	120 kg

- Adjustable feet 30/50 mm
- removable feet
- LED light inside
- Options : Lock

# BOTTLES-COOLERS

## with built-in cooling unit - GLASS DOORS



- Adjustable feet 30/50 mm
- removable feet
- LED light inside
- Options : Lock

- 2 shelves per door
- 3 storage levels
- LED lights
- Cooling unit on left side or right

	Ref.	Width Depth Height	Door width	Bottles Capacity 25 cl	Power con- sumption Compressor Voltage	Weight
	9000C 1540*200	1535 mm 550 mm 820 mm	2 554 mm	373	525 W 1/4 HP - PK R 134a 220 V-2,7 A	109 kg
	9000C 2140*200	2140 mm 550 mm 820 mm	3 554 mm	570	700 W 1/3 HP - PK R 134a 220 V-3,4 A	145 kg

# BOTTLE-COOLERS

## Built-in cooling unit - with sliding drawers



ref	type	Doors	Drawers
9000C1540*101	154	1	1 à 2
9000C1540*105	154	0	2 x 2
9000C2140*101	214	1+1	1 x 2
9000C2140*102	214	1	2 x 2
9000C2140*105	214	0	3 x 2



## 5. PYTHON LINES - CLEANING - ACCESSORIES



## Python-line polyethylene beer 3/8" water 1/2"

649C000*00100	2 beer lines + 2 water circulations interior Ø 12,7 mm insulation 19 mm Armaflex exterior Ø 70 mm
649C001*01000	3 beer lines + 2 water circulations interior Ø 12,7 mm insulation 19 mm Armaflex exterior Ø 70 mm
649C002*01000	4 beer lines + 2 water circulations interior Ø 12,7 mm insulation 19 mm Armaflex exterior Ø 70 mm
649C003*01000	5 beer lines + 2 water circulations interior Ø 12,7 mm insulation 19 mm Armaflex exterior Ø 70 mm
649C004*01000	6 beer lines + 2 water circulations interior Ø 12,7 mm insulation 19 mm Armaflex exterior Ø 70 mm
649C008*01000	7 and 8 beer lines + 2 water circulations interior Ø 12,7 mm insulation 19 mm Armaflex exterior Ø 70 mm



## Quick-coupling for python-lines and accesories

380C000*00003	PI 0416S union double equal 1/2"
380C005*00024	PI UB16S by-pass U 1/2"
380C015*00002	PI 221616S bend nipple 1/2"
380C015*00003	PI 0316S angled union equal 1/2"
380C001*00002	PI 0216S T 1/2"
380C006*00050	PI 251616S connector tube to hose stem 1/2"
649C100*00001	By-pass fitting in stainless steel Diameter entrance and exit 12,7 mm
649C100*00002	Pump - python fitting Diameter entrance: 8 mm Diameter exit: 12,7 mm



# Maintenance products & Tools

Ref.	Description	
<b>Plumbing tools</b>		
<b>Maintenance products</b>		
372C000*00000	Stainless steel tube cutter Short model	
373C000*00000	Stainless steel tube cutter Big model	
376C000*00003	Bending spring for stainless steel tube Ø 7/8	
376C000*00004	Bending spring for stainless steel tube Ø 8/9	
379C000	Cleaning sponges in sacks of 100 pieces. Ø 7, 8 or 9 mm.	
381C000*00001	Cleaning brush for outlet tap Ø 11 mm.	
382C000*00000	Cleaning brush for keg-coupler Alumasc	
382C000*00001	Cleaning brush for keg-coupler Sankey	
383C000*00003	Purexol in bottle of 1 L.	
383C000*00000	Purexol in bottle of 10 L.	
OUT*PRO*00001	Maintenance product for all metals PROTALL	
267C000*00010	Maintenance product for the cleaning of glasses BECHAREIN	
384C000*00100	Grease for tap in tube of 60 gr.	
385C000*00005	Cleaning adapter ECOTAP	
386C000*00000	Cleaning adapter DEBITAP	
389C000*00000	Electric cleaning pump MINIMAX	
348C000*0100	Professional thermometer waterproof -50°C to 300°C	
<b>Accessories for cleaning pump</b>		
346C006*00100	Rinsing adapter SANKEY / ALUMASC	
346C006*00101	Rinsing adapter SANKEY / SANKEY	
346C006*00102	Rinsing adapter ALUMASC / ALUMASC	
<b>Cleaning bottle</b>		
335CBID*09000	Stainless steel cleaning bottle 9 L. (3 couplers to determine)	
335CBID*09001	Stainless steel cleaning bottle 9 L. (5 couplers to determine)	

## 6.Cleaning & coupling heads / Pressure regulators



# CLEANING & COUPLINGS HEADS

Model	Description
338C000*00100	Alumasc head, without valve, tap and nipple
335C000*00100	Sankey head, without valve, tap and nipple
335C006*00000	Keykeg head with decompression valve, without J.G.
338C000*00080	Alumasc head with stop valve and integrated JG 3/8
335C000*00080	Sankey head with stop valve and integrated JG 3/8
335C006*00001	Keykeg head with decompression valve with J.G.
338C000*JO1000	Set of gaskets for Alumasc head
335C000*JO1000	Set of gaskets for Sankey head
346C004*00001	Kit of cleaning head Alumasc
346C003*00001	Kit of cleaning head Sankey
346C005*00000	Kit of cleaning head Keykeg



339C000\*00101 Angle valves for flow head



Sankey



Alumasc



Grundy



Keykeg



# Pressure regulators

Model	Description
	<b>Premium regulator</b> - with high and low pressure manometer
301	1 exit
302	2 exits
303	3 exits
306	2 exits

305	<b>Intermediate regulator</b> - With manometer 1 exit
-----	---

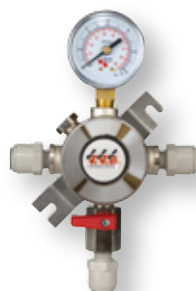

302C00\*01500 **Double level regulator**  
1,5 Bar - 1 exit



## Pressure gallery

With premium regulator fixed on gallery,  
with high pressure cable  
equipped with:

319	2-way distributor
320	3-way distributor
321	2 intermediate regulators 1 exit
322	1 intermediate regulator 1 exit 1 intermediate regulator 2 exits
324	3 intermediate regulators 1 exit
328	4 intermediate regulators 1 exit
329	5 intermediate regulators 1 exit



## 7. PARTY COOLERS



# SAFARI

	SAFARI 20 SUPER	SAFARI 50 HYPER
	491C100*00000 491C100*00100	492C100*00000
Taps	1-2	2
Compressor HP - Power	1/4 432 W	1/3 579 W
Ice bank	7 kg	35 kg
Water tank	17 L	50 L
Agitator	Yes	Yes
Dimensions (WxDxH)	520x370x410 mm	732x427x490 mm
Weight	32 kg	43 kg
Performance L/H	97	197
Kit CO2	Yes	Yes

Not included : coupling head  
Structure for Safari : R495



Super



Hyper



# TAPSTAR II



TAPSTAR II	R402	R403
Taps	1	2
Compressor HP	1/4	1/4
Ice bank	8 L	8 L
Water tank	20 L	20 L
Agitator	1500 R/M	1500 R/M
Pump python		
Height	560 mm	560 mm
Depth	690 mm	690 mm
Width	325 mm	325 mm
Weight	30kg	30kg
Performance	50 L/H	50 L/H

Built-in CO<sub>2</sub> kit

Not included : Coupling heads



## PROMOTAP (Watertight tank)

PROMOTAP	
	R 406C001*01000
Taps	1
Compressor HP	1/5
Ice bank	2 kg
Cuve étanche	6 L
Agitator	1500 R/M
Python Pump	
Dimensions (WxDxH)	500x340+150x350 mm
Weight	30 kg
Performance	30 L/H
Kit CO <sub>2</sub>	Yes

Built-in CO<sub>2</sub> kit

Not included : Coupling heads

# TIPTAP



1-2 t

## TIP TAP

R 404C000\*00000

Taps	1 - 2
Compressor HP	1/4 HP
Ice bank	6 kg
Water tank	20 L
Agitator	2 M
Dimensions (WxDxH)	630x450x290 mm
Weight	23 kg
Performance	50 L/H



## TIP TAP + TRANSPORT CART

Finish	Stainless steel
Dimensions (WxDxH)	650x420x1540 mm
Taps	1
Performance	50 L/H
Option	Kit CO <sub>2</sub>
Not included	Pression regulator - Coupling heads



Available space under the cart  
Dimension (WxDxH): 650x 420x800 mm



# BREUGHEL COMPACT



## BREUGHEL 400 COMPACT

R 496C01\*00200

Taps	2
Compressor HP	1
Icebank	45 kg
Watertank	90 L
Dimensions (WxDxH)	530 x 680 x 1110 mm
Weight	73 kg
Performance	200 L/H

Built-in CO<sub>2</sub> kit

Not included : Coupling heads

**Easy to transport**

**Reduced height 1110 mm !**



# BREUGHEL

## BREUGHEL

R 497C000\*00000 - 498C000\*00000

DOUBLE EVAPORATOR	
Taps	2 - 3
Compressor HP	1
Icebank	45 kg
Watertank	90 L
Dimensions (WxDxH)	620 x 675 x 1550 mm
Weight	78 kg
Performance	200 L/H

Built-in CO<sub>2</sub> kit

Not included : Coupling heads



# EVENT - COOLER

	1/3 Hp 60L	1/2 Hp 90L	1 Hp 90L
	499C000*00000 499C100*00000	499C600*00000	499C800*00000
Dimensions (WxDxH)	400x400x1505 mm	535x525x1476 mm	545x525x1551 mm
Taps	1 - 2	2	2
Weight	69 kg	79 kg	80 kg
Compressor	1/3 HP - PK	1/2 HP - PK	1 HP - PK
Performance (L/H)	107 L	288 L	376 L
Power	230 V / 50 Hz	230 V / 50 Hz	230 V / 50 Hz
Performance HP (0°)	375 W	540 W	1050 W
Type of gas	R134a	R134a	R134a
Thermostat	Mec. -2°C/+10°C	Mec. -2°C/+10°C	Mec. -2°C/+10°C
Icebank	22 kg	45 kg	45 kg
Watertank	50 L		
Drainer valve	Yes	Yes	Yes

Built-in co<sub>2</sub> kit  
Not included : Coupling heads



# ROLL BAR G88

## Description

R500C000\*00000  
 Dimensions : 865 x 530 x 1500 mm (WxDxH)  
 1 Banco 1/2 HP 90 L  
 2 coils + agitator 2500 t/m  
 1 drainer half-lined 800 x 500 mm 2 holes  
 2 New-Anfo simple chromed  
 4 Wheels Ø 125 mm (2 with brakes)  
 With holes for parasol  
 Removable panels



1 - 3 taps



## Description

R500C000\*00100  
 Dimensions : 865 x 530 x 1500 mm (WxDxH)  
 1 Sink 800 x 500 mm  
 2 sinks in the center + accessories



## Description

R500C000\*00200  
 Dimensions : 865 x 530 x 1000 mm (WxDxH)  
 Removable panels  
 1 drainer lined 800 x 500 mm for glasses  
 Accessories



## ROLL BAR GT108 «EXTENSO»



1 - 3 TAPS

Option  
Service tablet

### Description

R501C000\*00000

Dimensions : 1080 x 530 x 1500 mm (WxDxH)

2 pliable tablets 460 x 530 mm

Total length when opened: 1820 mm

Total length when closed: 970 mm

1 Banco 1/2 HP 90 L

2 coils 25m 7/8 + agitator 2500 RPM

1 drainer half-lined 80 x 50 cm 2 holes

2 New-Anfo 1 tap chromed (Not illuminated)

4 wheels Ø 125 mm (2 with brakes)

With holes for parasol and removable panels



## ROLL BAR GT160 ALL-IN-ONE



1 - 3 TAPS

Option  
Service tablet

### Description

R501C000\*00320

Dimension : 1600x530x1500 mm (WxDxH)

2 pliable tablets 440x530 mm

Total length when opened: 2480 mm

1 drainer - sink 1500x500x50 mm

2 sinks, 2 funnels, 1 cold water tap

2 American columns chromed (Not illuminated)

1 banco 1/2 HP 90 L

2 coils of 25 m 7/8 + agitator 2500 RPM

4 wheels Ø 125 mm (2 with brakes)

With holes for parasol and removable panels

Option: Kit CO2 and coupling heads



## ROLL BAR GT XL



1 - 4 TAPS

Option  
Service tablet

### Description

501C160\*0002

Dimension : 1600 x 630 x 1500 mm (WxDxH)

Total length with tablets: 2480 mm

### Equipped with:

- 2 pliable tablets 440 x 630 mm
- 1 banco 3/4 HP 144L. Extra Large / Icebank 80 kg
- 2 coils + agitator 2500 T & drain tap
- 1 drainer - sink 150 x 60 cm, 2 holes
- 2 towers USA 1 tap - chromed
- 4 wheels Ø 125 - 2 with brakes
- With holes for parasol and removable panels

### Alternatively:

501C160\*00003

with 3 towers USA 1 tap - chromed

501C160\*00004

with 4 towers USA 1 tap - chromed





# SPEEDTAP

Description
REF : 504C000*0000
Dimensions (WxDxH) : 1500x620x1337 mm
4 Alpha II taps
Tower : Adjustable height and tilt
Compressor : 1 CV
Power : 230V / 50Hz - 5,10 A
Cooling capacity @ 0°C : 2714 W
Power consumption @ 0°C : 1050 W
Type of gas : R-134
Thermostat : -2C° à + 10C°
Icebank max :85kg
4 Coils of 25 m
4 big wheels with brake
Waterbath : 144 liters
Built-in co2 regulator
Drain valve included
1 Set of 3 grey panels
3 aluminium trays for 16 glasses included



<https://youtu.be/blSQKOPeNNk>

Non-contractual photos

© ANTOINE



# ICE-MACHINES

## with built-in storage space

Ref.	Description	
R801C000*00001	<p>Model IM-30 CLE  Maximal production in 24 hours: 28 KG  Storage capacity: 11 KG  Length: 398 mm  Width: 495 + 6 mm  Height: 695 + 10 mm  Capacity: 250 W/H</p> <p>Pure and compact ice  Last longer  Stainless steel housing for hygiene and a longer lifetime.</p>	
R801C000*00002	<p>Model IM-45 CLE  Maximal production in 24 hours: 45 KG  Storage capacity: 15 KG  Length: 633 mm  Width: 506 + 6 mm  Height: 690 + 10 mm  Capacity: 300 W/H</p> <p>Pure and compact ice  Last longer  Stainless steel housing for hygiene and a longer lifetime.</p>	
R801C000*00003	<p>Model IM-65 LE  Maximal production in 24 hours: 64 KG  Storage capacity: 26 KG  Length: 633 mm  Width: 506 + 6 mm  Height: 850 + 10 mm  Capacity: 420 W/H</p> <p>Pure and compact ice  Last longer  Stainless steel housing for hygiene and a longer lifetime.</p>	
R801C000*00005	<p>Model IM-100 CLE  Maximal production in 24 hours: 97 KG  Storage capacity: 50 KG  Length: 704 mm  Width: 506 + 6 mm  Height: 1200 + 10 mm  Capacity: 610 W/H</p> <p>Pure and compact ice  Last longer  Stainless steel housing for hygiene and a longer lifetime.</p>	

# Conditions de vente

## GÉNÉRALITÉS :

1. Sauf convention contraire et écrite, nos prix s'entendent nets hors TVA, sans escompte, rabais ou déduction.
2. Les transactions négociées par nos agents ne deviennent valables et définitives qu'après avoir été acceptées et confirmées par nous.
3. Toutes réclamations sur factures ou ayant trait aux marchandises doivent, pour être valables, être introduites dans la huitaine et par écrit.
4. Toute marchandise reste notre propriété jusqu'au paiement intégral de la facture.
5. La S.A. ANTOINE se réserve également le droit de modifier, sans préavis préalable, les caractéristiques et les équipements des produits présentés.

## PAIEMENTS :

6. Nos factures de dépannages et enlèvement marchandise sont payables au grand comptant sauf convention spéciale entre les 2 parties.
7. Les autres factures sont payables 30 jours fin de mois, date de facturation.
8. Par le seul fait de défaut de paiement à l'échéance et sans qu'il soit besoin de mise en demeure écrite, le montant de la facture restant dû, sera majoré de plein droit d'une indemnité forfaitaire de 10% en réparation du dommage causé par la faute de l'acheteur, avec un minimum de 25 € sans préjudice au droit éventuel du débiteur de solliciter des délais de grâce, dans les conditions prévues par l'article 1244 du Code Civil.
9. Un intérêt de 10% l'an est dû de plein droit à défaut de paiement à l'échéance indiquée, sans qu'une mise en demeure ne soit nécessaire.

## COMPÉTENCE :

10. Toute contestation éventuelle est de la compétence des Tribunaux de Bruxelles et le cas échéant la Justice de Paix du 2ième canton de Bruxelles.

## PARTICIPATION DANS LES FRAIS ADMINISTRATIFS :

11. Pour la rédaction de factures de 12,50 € et moins, une somme de 2,50 € sera réclamée à titre de participation dans les frais administratifs. Tous nos produits sont garantis, suivant les conditions suivantes :

## GARANTIE :

- I) Matériel plomberie :  
(colonnes - robinets – matériel de comptoirs et de cave):  
12 mois sur défaut d'origine usure anormale sauf utilisation de produit non-conforme. Après 6 mois, en cas de remplacement en clientèle, les frais de déplacement ne sont pas inclus dans « la garantie »
- II) Matériel frigorifique :  
Garantie ; 2 ans : pièces - déplacement main d'œuvre – circuit de gaz - thermostat - ventilateur - condenseur - compresseur – autres défauts. 12 mois sur les joints de portes sauf mauvaise manipulation et manque d'entretien.

Le client exécutera pour son propre compte les travaux indiqués dans le manuel d'instructions fourni avec l'appareil. Par travaux, il faut entendre l'entretien de l'appareil de réfrigération en « bon père de famille ». Le client s'engage à n'apporter (ne faire apporter) aucune modification ni aucun complément à l'appareil sans autorisation écrite préalable de la S.A. ANTOINE.

## NON COUVERTS PAR LA GARANTIE :

Défectuosité suite à un manque d'entretien  
Défectuosité due à une utilisation inadaptée  
Défectuosité suite à des facteurs extérieurs  
Nettoyage du condenseur  
Remplacement d'une lampe ou des joints des portes  
Décharge bouchée par l'eau de condensation  
Réglage du thermostat

La S.A. ANTOINE exclut sa responsabilité pour les dommages, la perte de chiffre d'affaires et les dommages subséquents liés à un fonctionnement inapproprié de l'appareil relevant de la présente garantie. Cette exclusion de responsabilité ne vaut toutefois pas pour des dommages qui seraient la conséquence directe d'une intention ou d'une faute grave de la S.A. ANTOINE.

# Verkoopsvoorwaarden

## ALGEMEENHEDEN :

1. Behoudens tegengestelde en geschreven overeenkomst zijn onze prijzen netto excl. BTW, zonder disconto, afslag of vermindering.
2. De verhandelingen bedongen door onze agenten worden dan slechts van kracht, als zij door ons aanvaard en bevestigd worden.
3. Alle klachten met betrekking op facturen of geleverde goederen, moeten om geldig te zijn, binnen de acht dagen schriftelijk ingediend worden.
4. De goederen blijven onze eigendom tot de volledige afbetaling van de factuur.
5. De firma ANTOINE NV behoudt zich het recht om, zonder voorafgaande verwittiging, de karakteristieken en materialen van de geïmporteerde producten aan te passen.

## BETALING:

6. Onze facturen voor herstellingen en afhaling van materiaal zijn contant betaalbaar, behalve speciale overeenkomst van de 2 partijen.
7. De andere facturen zijn betaalbaar, 30 dagen na factuurdatum.
8. Bij niet-betaling op de vervaldag en zonder dat de ingebrekestelling, schriftelijk bevestigd wordt, zal het bedrag van de factuur van rechtswege verhoogd worden met een forfaitaire schadevergoeding van 10%, met een minimum van 25 € zonder het eventuele recht van de schuldenaar te ontnemen, om termijnen van uitstel te vragen, zoals voorzien bij artikel 1244 van het Burgerlijk Wetboek.
9. Een interest van 10% 's jaar is van rechtswege verschuldigd bij gebrek aan betaling op de vastgestelde vervaldag, zonder dat een aanmaning noodzakelijk is.

## BEVOEGDHEID:

10. Eventuele betwistingen behoren tot de bevoegdheid van de Brusselse Rechtbanken en in voorkomend geval het Vredegerecht van het 2de kanton van Brussel.

## DEELNAME IN ADMINISTRATIEVE KOSTEN :

11. Voor het opstellen van facturen, ten bedrage van 12,50 € en minder, zal een bedrag van 2,50 € aangerekend worden ten titel van deelname in de administratieve kosten.

## GARANTIE:

- I) Materiaal loodgieter :  
(zuilen – kranen – toog- en keldermateriaal) :  
12 maanden op gebreken van abnormale slijtage, uitgezonderd gebruik van niet conforme producten. Na 6 maanden, zijn de verplaatsingskosten niet inbegrepen in de garantie. ( indien vervanging bij de klant zelf.)
- II) Koeltechnisch materiaal :  
Garantie 2 jaar : stukken – verplaatsingskosten – gascircuit - thermostaat – ventilator – condensor – compressor – andere gebreken of defecten. 12 maanden op deurdichtingen uitgezonderd slechte handeling en gebrek aan onderhoud.

De klant zal de werkzaamheden beschreven in de gebruiksaanwijzing van het apparaat op eigen rekening uitvoeren. Met werkzaamheden, wordt in dit context bedoeld het onderhoud van koelinstallatie als "goede vader". De klant verbindt zich ertoe geen enkele aanpassing aan het toestel te maken, noch toevoegingen uit te voeren, zonder voorafgaande schriftelijke toestemming van de firma ANTOINE N.V.

## VALLEN NIET ONDER GARANTIE :

Defect te wijten aan een gebrekkig onderhoud.  
Defect te wijten aan een slecht gebruik.  
Defect te wijten aan externe factoren.  
Reiniging van de condensor.  
Vervanging van een lamp of van de deurdichtingen  
Verstopte afloop van condensatiewater.  
Regelen van de thermostaat.

De N.V. ANTOINE wijst alle verantwoordelijkheid af voor eventuele schade en verlies in zakencijfer ten gevolge van ondeugdelijk gebruik van het apparaat dat onder garantie valt. Deze afwijzing geldt echter niet voor schade die het directe gevolg is van een grove fout of door opzet van de NV ANTOINE.



## SIÈGE CENTRAL/HOOFDZETEL

### BRUXELLES /BRUSSEL

Rue de la Bienvenue, 7-9 • 1070 Bruxelles  
Verwelkomingsstraat 7-9 • 1070 Brussel

**Antoine:** Tél +32 (2) 523 94 30 • Fax +32 (2) 520 06 18  
info@antoinebelgium.be • www.antoine-belgium.com



### BELGIQUE/BELGIË

#### BRUXELLES/BRUSSEL

Rue de la Bienvenue, 7-9  
1070 Bruxelles  
Verwelkomingsstraat 7-9  
1070 Brussel  
Tél +32 (2) 523 94 30  
Fax Antoine +32 (2) 520 06 18  
info@antoinebelgium.be  
www.antoine-belgium.com  
www.vvb.be

#### LIEGE

Rue de l'Estampage, 14  
4340 Awans  
Tél.: 04-247 23 27  
Fax: 04/246 05 40

#### GENT

Brugse Vaart, 52-53  
9030 Mariakerke  
Tel.: 09-227 94 84  
Fax: 09-227 77 13



### LUXEMBOURG/LUXEMBURG

#### ATS

Rue Steinfort 2A  
L-8476 Eischen  
Tél.: +352 26 81 12 67  
Fax +352 26 81 14 47

### LUXEMBOURG ATS

### BELGIUM Antoine/VVB

#### FRANCE

#### ITALY

#### CZECH REPUBLIC

#### FINLAND

#### POLAND

#### ISRAEL

#### INDIA

#### SHANGHAI CHINA

#### SOUTH KOREA

#### AUSTRALIA & NEW ZEALAND

#### CANADA & USA

#### PERU & CHILE

#### BRAZIL

